

*moda*

# Be My Neighbor

## Block 1

18" x 18" finished

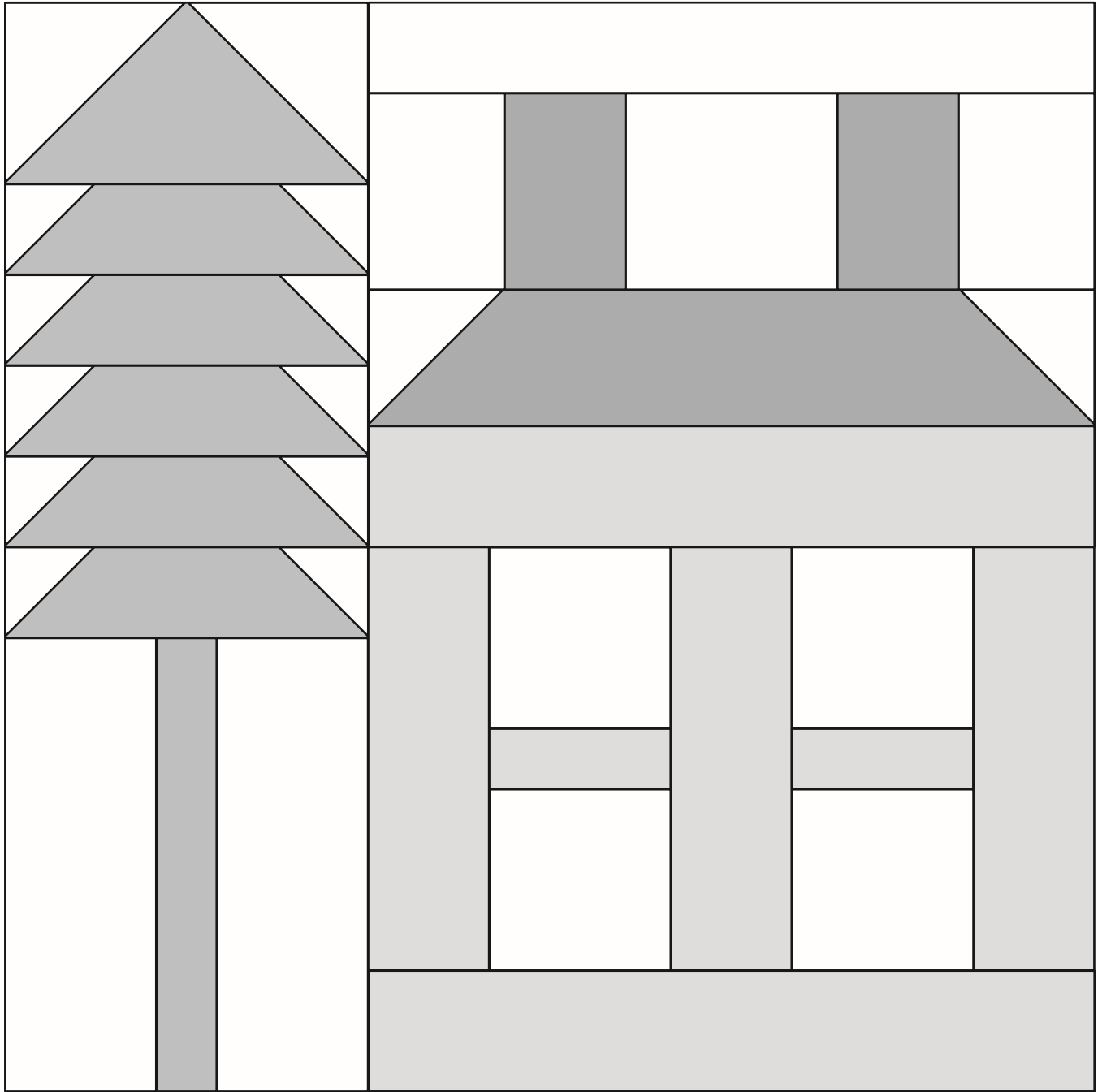

## General Information

- These are very scrappy blocks. Mix your favorite Moda prints to create your colorful neighborhood!
- Share your progress and final quilt at #BeMyNeighbor. We love to see your results!!!

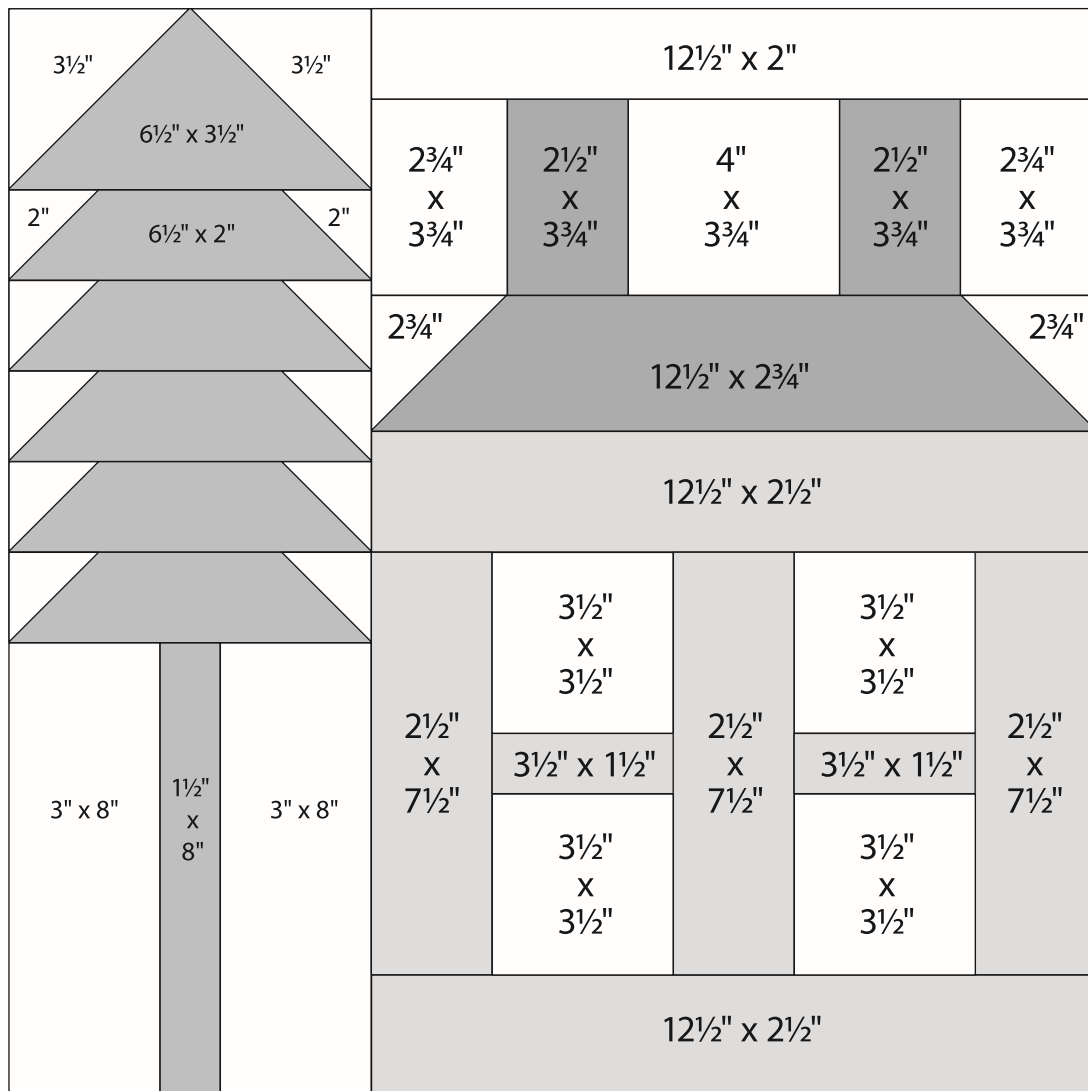

**Block 1**  
18 1/2" x 18 1/2" unfinished

## Cutting

### House

- 2-12 1/2" x 2 1/2" rectangles
- 2-3 1/2" x 1 1/2" rectangles
- 3-2 1/2" x 7 1/2" rectangles

### Windows

- 4-3 1/2" squares

### Roof and Chimneys

- 1-12 1/2" x 2 3/4" rectangle
- 2-2 1/2" x 3 3/4" rectangles

### Tree

- 1-6 1/2" x 3 1/2" rectangle
- 5-6 1/2" x 2" rectangles

### Tree Trunk

- 1-1 1/2" x 8" rectangle

### Background

- 10-2" squares
- 1-2" x 12 1/2" rectangle
- 2-2 3/4" squares
- 2-2 3/4" x 3 3/4" rectangles
- 1-3 3/4" x 4" rectangle
- 2-3" x 8" rectangles
- 2-3 1/2" squares



# moda Be My Neighbor

Block 1 is 18" x 18" finished.

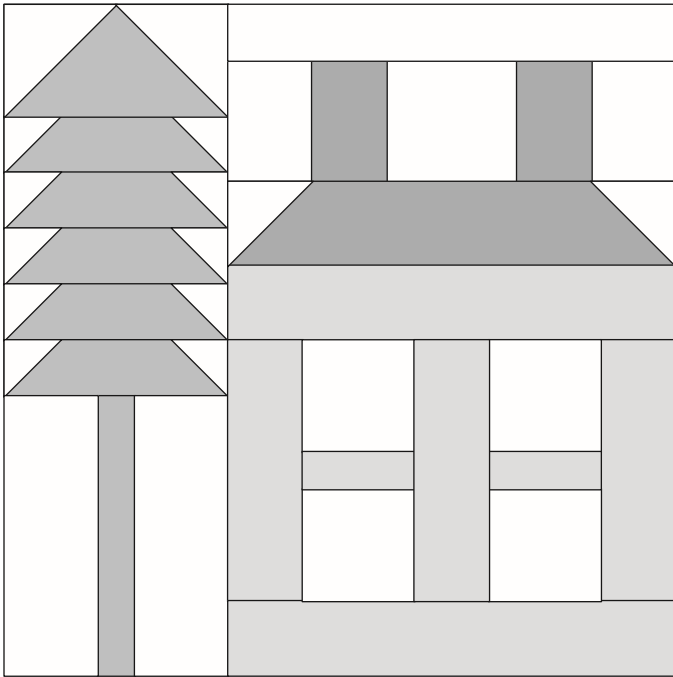

## Construction

Use  $\frac{1}{4}$ " seams. Press in the direction of the arrows in the diagrams.

### 1 Tree

(A) Draw a diagonal line from corner to corner on the wrong side of 2– $3\frac{1}{2}$ " background squares. Layer a  $3\frac{1}{2}$ " marked background square, right sides together, on 1– $6\frac{1}{2}$ " x  $3\frac{1}{2}$ " tree rectangle as shown. Sew on the diagonal line. Trim  $\frac{1}{4}$ " from the sewn line. Press to reveal the triangle. Repeat on the opposite end of the same rectangle. Make 1.

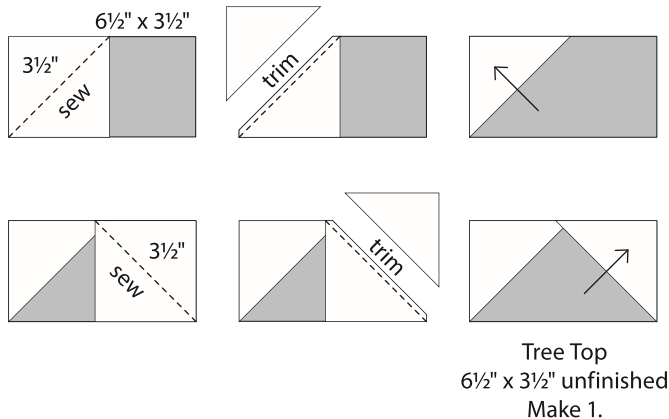

tree continued . . . . .

(B) Draw a diagonal line from corner to corner on the wrong side of 10–2" background squares. Layer 2" marked background square, right sides together, on 1– $6\frac{1}{2}$ " x 2" tree rectangle as shown. Sew on the diagonal line. Trim  $\frac{1}{4}$ " from the sewn line. Press to reveal the triangle. Repeat on the opposite end of the same rectangle. Make 5.

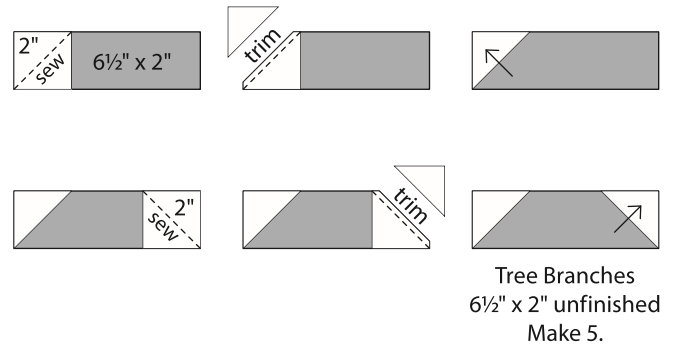

(C) Join 2–3" x 8" background and 1– $1\frac{1}{2}$ " x 8" tree trunk as shown. Make 1.

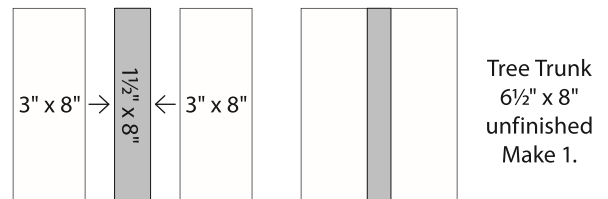

(D) Assemble the tree as shown.

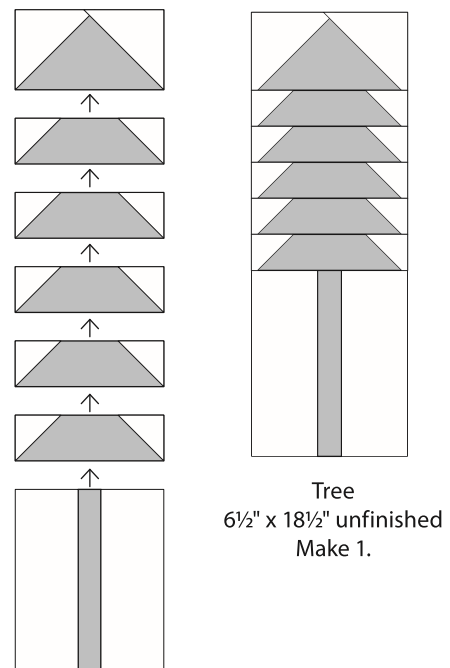

## 2 Chimney, Roof, and Windows

(A) Join  $2-2\frac{3}{4}'' \times 3\frac{3}{4}''$  backgrounds,  $2-2\frac{1}{2}'' \times 3\frac{3}{4}''$  chimneys, and  $1-4'' \times 3\frac{3}{4}''$  background as shown to make the chimneys.

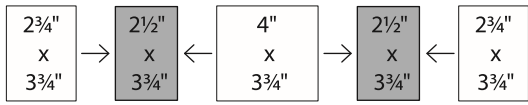

Chimneys  
 $18\frac{1}{2}'' \times 3\frac{3}{4}''$  unfinished  
Make 1.

(B) Draw a diagonal line from corner to corner on the wrong side of  $2-2\frac{3}{4}''$  background squares. Layer a  $2\frac{3}{4}''$  marked background square, right sides to together, on  $1-12\frac{1}{2}'' \times 2\frac{3}{4}''$  roof rectangle as shown. Sew on the diagonal line. Trim  $\frac{1}{4}''$  from the sewn line. Press to reveal the triangle. Repeat on the opposite end of the same rectangle.

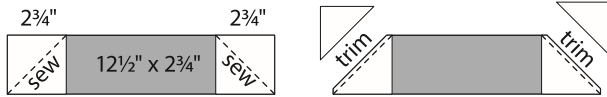

Roof  
 $12\frac{1}{2}'' \times 2\frac{3}{4}''$  unfinished  
Make 1.

(C) Assemble the windows as shown.

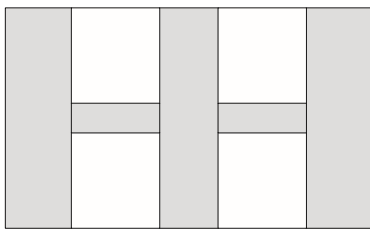
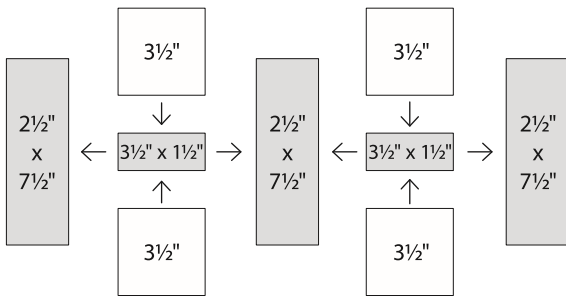

Window  
 $12\frac{1}{2}'' \times 7\frac{1}{2}''$  unfinished  
Make 1.

## 3 Assemble the house as shown.

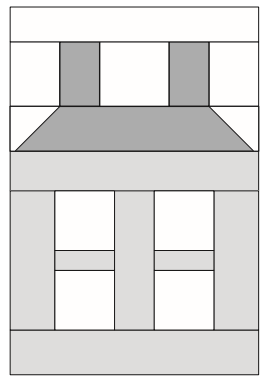
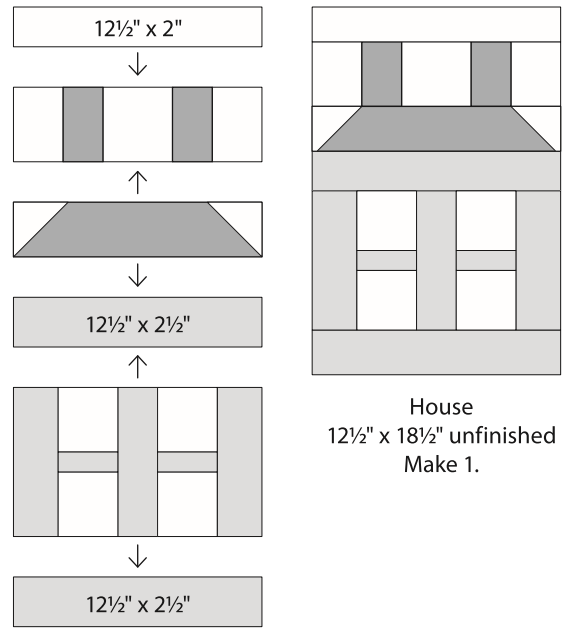

House  
 $12\frac{1}{2}'' \times 18\frac{1}{2}''$  unfinished  
Make 1.

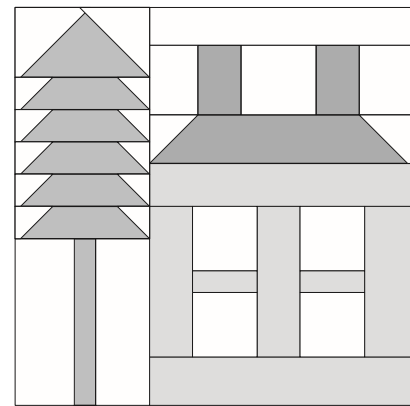
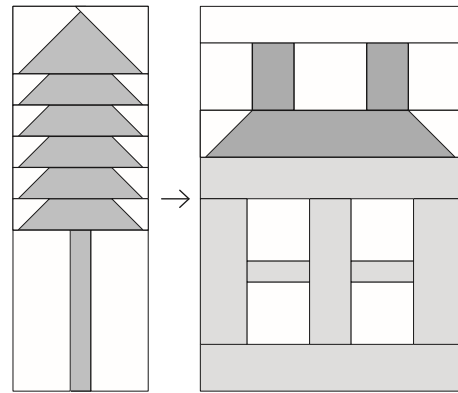

Block 1  
 $18\frac{1}{2}'' \times 18\frac{1}{2}''$  unfinished.

*moda*



*moda*

# Be My Neighbor

**Block 2**  
15" x 18" finished

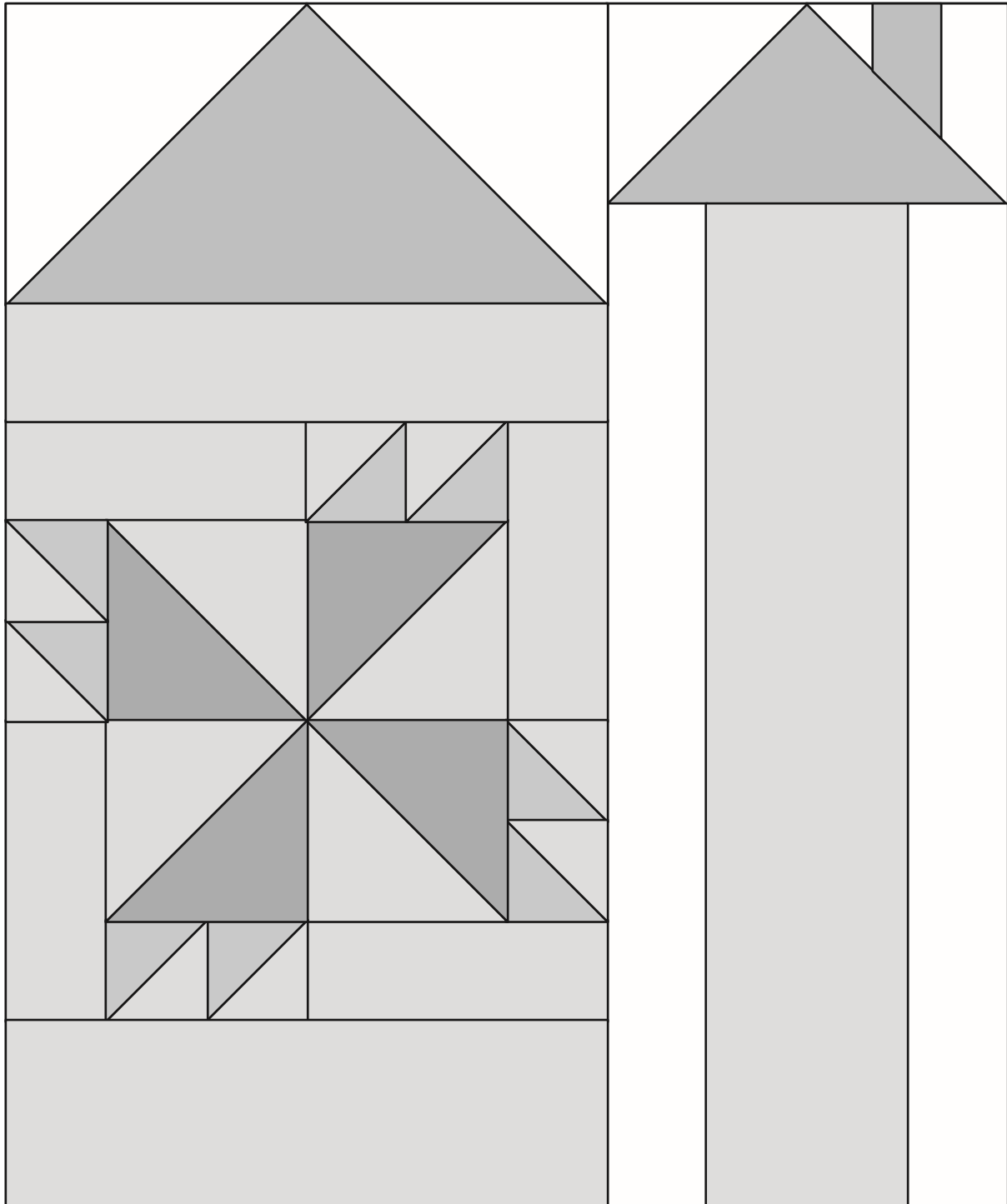

## General Information

- These are very scrappy blocks. Mix your favorite Moda prints to create your colorful neighborhood!
- Share your progress and final quilt at #BeMyNeighbor. We love to see your results!!!

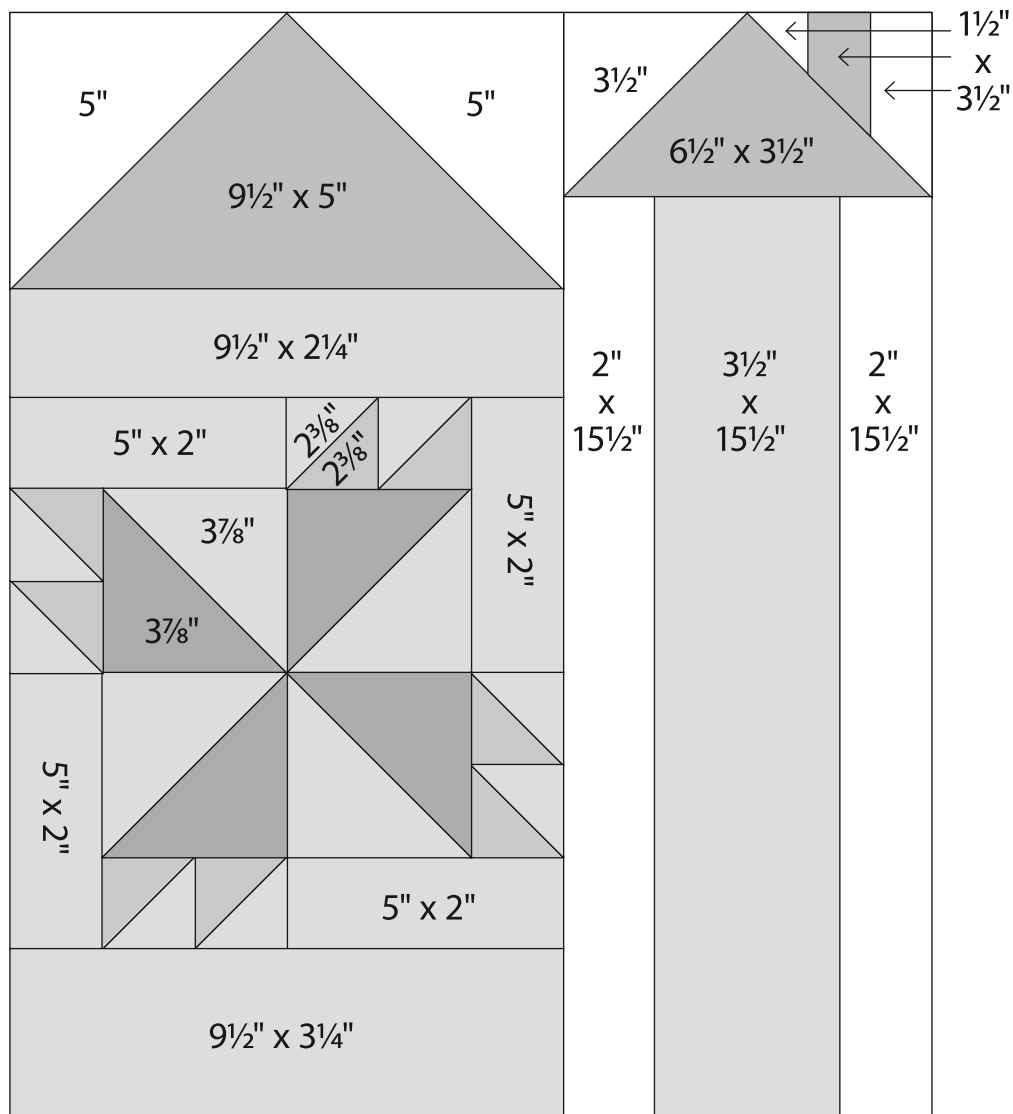

**Block 2**  
15½" x 18½" unfinished

## Cutting

### House

- 1–9½" x 3¼" rectangle
- 1–9½" x 2¼" rectangle
- 4–5" x 2" rectangles
- 2–3⅞" squares
  - cut in half once on the diagonal to make 4 half-square triangles
- 4–2⅜" squares
  - cut in half once on the diagonal to make 8 half-square triangles

### House Roof

- 1–9½" x 5" rectangle

### Pinwheel

- 2–3⅞" squares
  - cut in half once on the diagonal to make 4 half-square triangles

### Pinwheel Points

- 4–2⅜" squares
  - cut in half once on the diagonal to make 8 half-square triangles

### Tower

- 1–3½" x 15½" rectangle

### Tower Roof

- 1–6½" x 3½" rectangle

### Tower Chimney

- 1–3½" x 1½" rectangle

### Background

- 2–5" squares
- 1–3½" square
- 2–3½" x 1½" rectangles
- 2–2" x 15½" rectangles



# Be My Neighbor

moda

Block 2 is 15" x 18" finished.

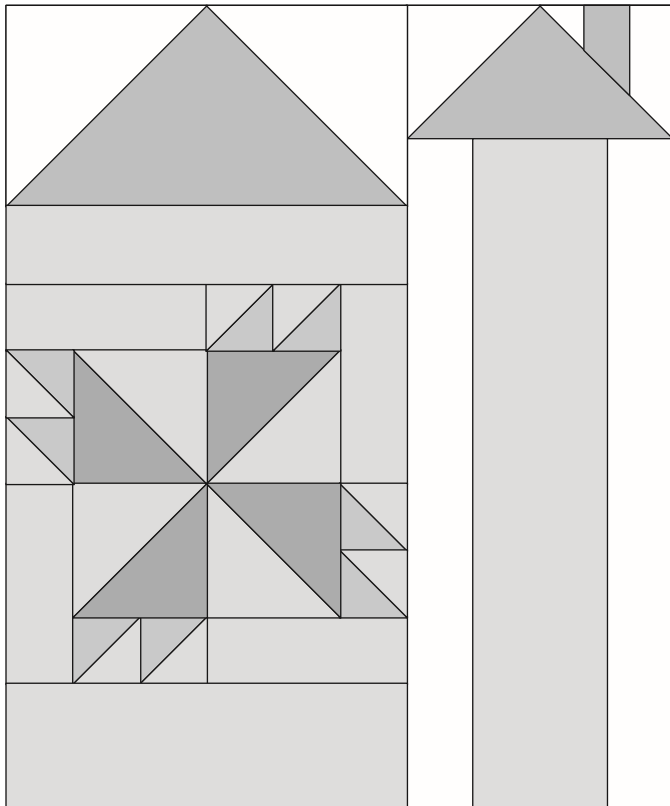

## Construction

Use 1/4" seams. Press in the direction of the arrows in the diagrams.

### 1 House Roof

Draw a diagonal line from corner to corner on the wrong side of 2-5" background squares. Layer a 5" marked background square, right sides to together, on 1-9 1/2" x 5" roof rectangle as shown. Sew on the diagonal line. Trim 1/4" from the sewn line. Press to reveal the triangle. Repeat on the opposite end of the same rectangle. Make 1.

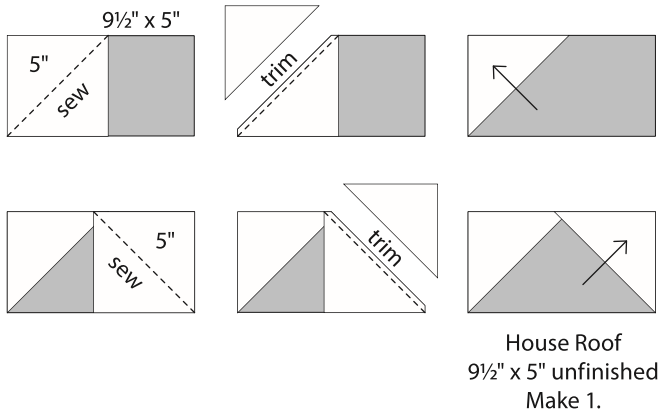

### 2 Pinwheel with points

(A) Join one 2 3/8" house and one 2 3/8" point half-square triangle to make a 2" point half-triangle square. Make 8. Join 2 HTSs to make 1 point pair. Make 4.

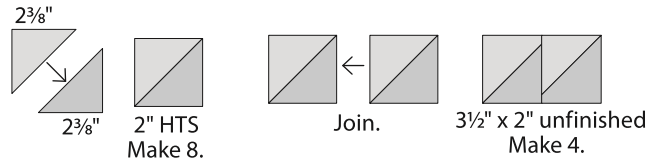

(B) Join one 3 7/8" house and one 3 7/8" pinwheel half-square triangle to make a 3 1/2" pinwheel half-triangle square. Make 4.

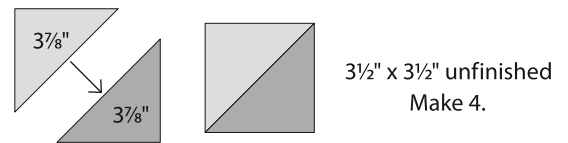

(C) Assemble a pointed pinwheel as shown.

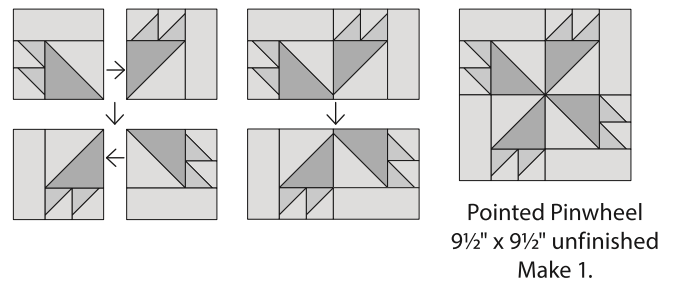
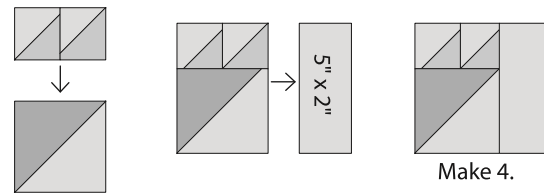

3 Assemble the house as shown.

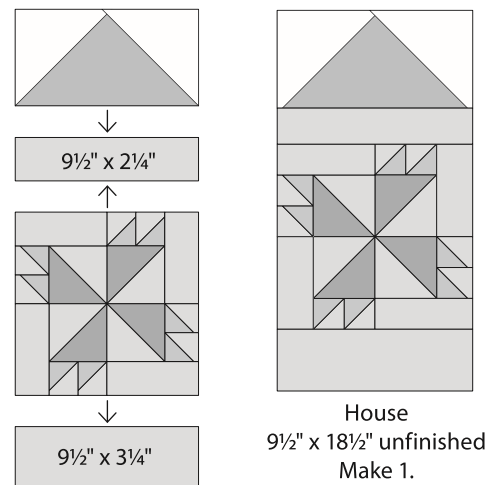

#### 4 Assemble the tower.

(A) Join 2-1½" x 3½" backgrounds and 1-1½" x 3½" chimney to make the chimney.

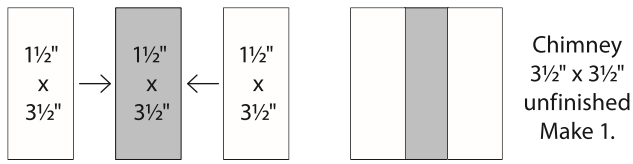

(B) Draw a diagonal line from corner to corner on the wrong side of the chimney square and a 3½" background square. Layer the marked background square, right sides to together, on 1-6½" x 3½" roof rectangle as shown. Sew on the diagonal line. Trim ¼" from the sewn line. Press to reveal the triangle. Repeat on the opposite end of the same rectangle using the marked chimney square. Make 1.

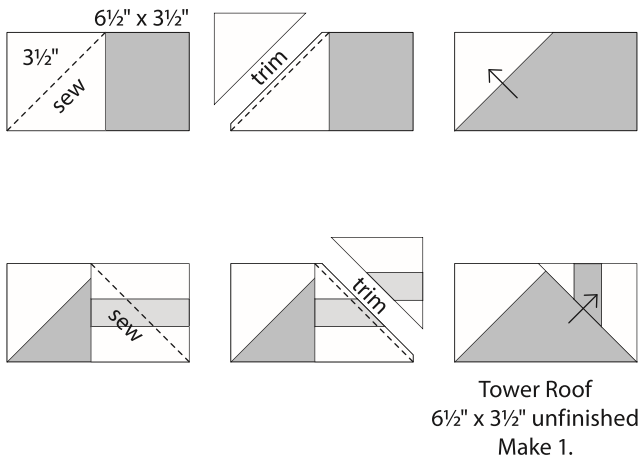

(C) Join 2-2" x 15½" backgrounds and 1-3½" x 15½" tower as shown.

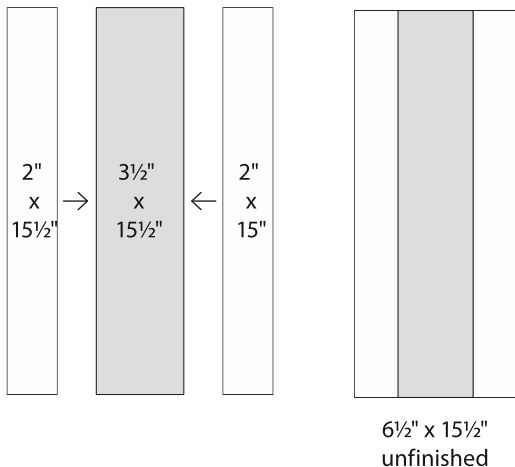

(C) Add the roof to finish the tower.

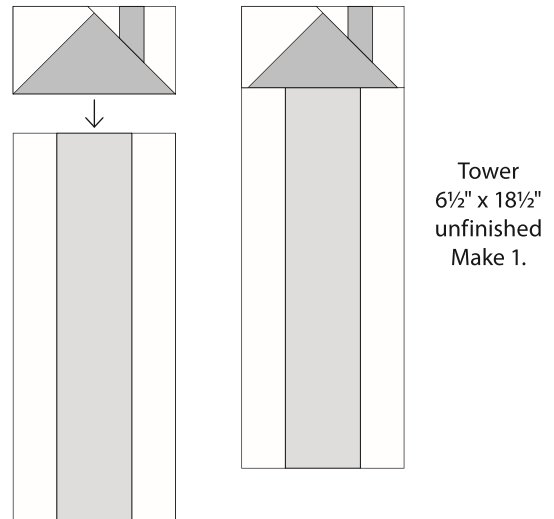

*moda*

#### 5 Assemble the block as shown.

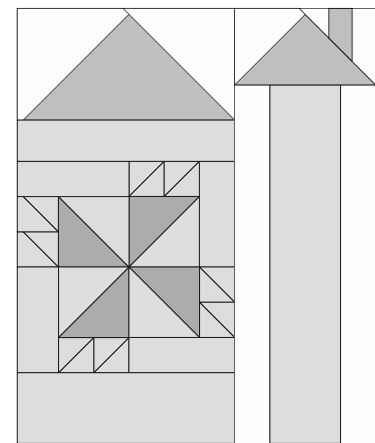
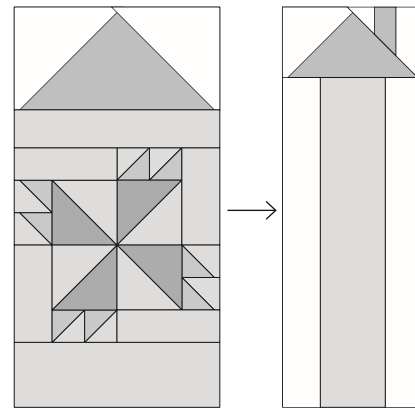



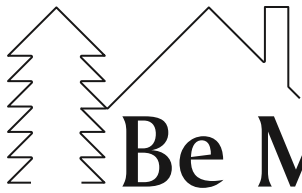

*moda*

# Be My Neighbor

**Block 3**  
15" x 18" finished

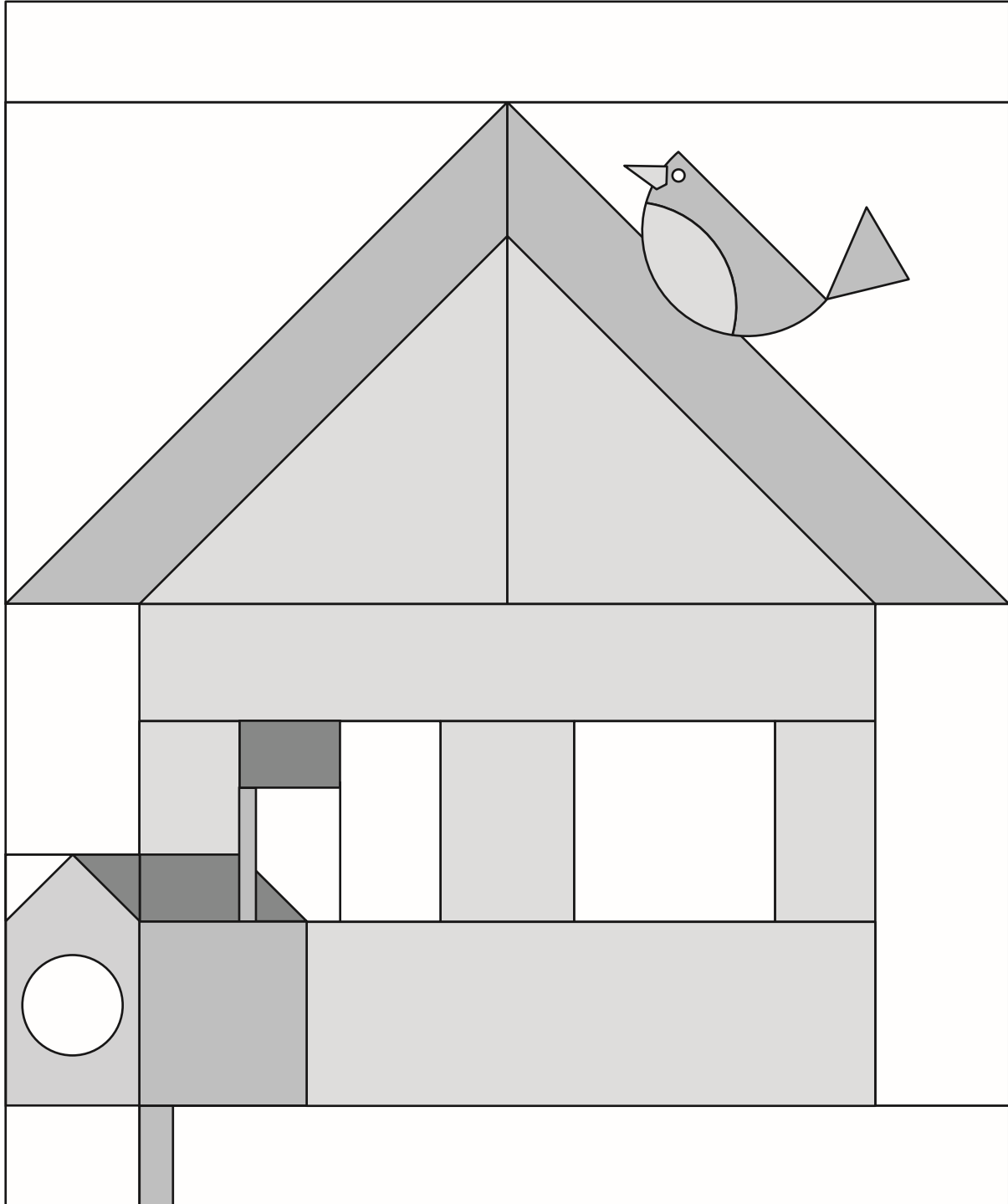

## General Information

- These are very scrappy blocks. Mix your favorite Moda prints to create your colorful neighborhood!
- Share your progress and final quilt at #BeMyNeighbor. We love to see your results!!!

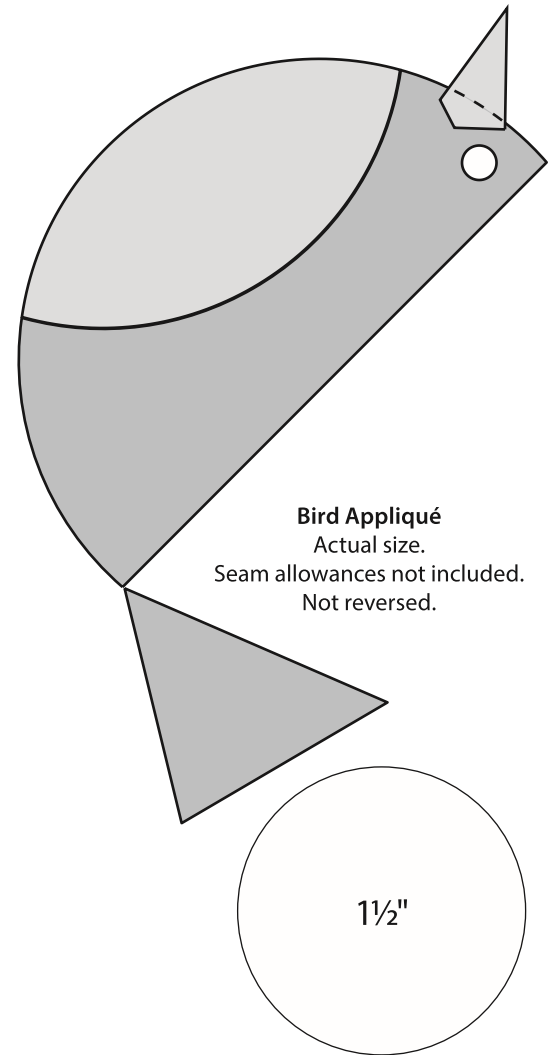
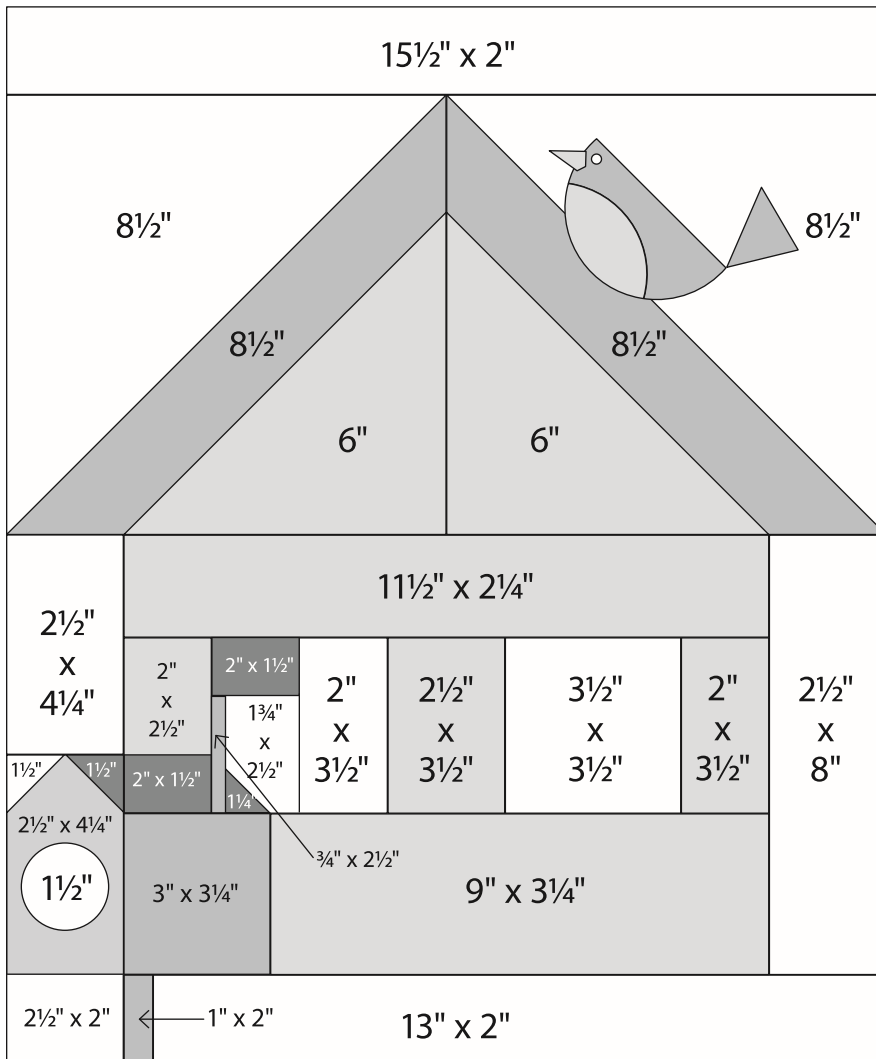

**Block 3**  
15½" x 18½" unfinished

## Cutting

### House

- 1-11½" x 2¼" rectangle
- 1-9" x 3¼" rectangle
- 2-6" squares
- 1-2½" x 3½" rectangle
- 1-2" x 3½" rectangle
- 1-2" x 2½" rectangle

### House Roof

- 1-8½" square  
cut in half once on the diagonal to make 2 half-square triangles

### Mailbox Front

- 1-2½" x 4¼" rectangle
- 1-1½ circle

### Mailbox Side and Pole

- 1-3" x 3¼" rectangle
- 1-1" x 2" rectangle

### Mailbox Roof

- 1-1¼" square
- 1-1½" square
- 1-2" x 1½" rectangle

### Windows

- 1-3½" square
- 1-2" x 3½" rectangle
- 1-1¾" x 2½" rectangle

### Flag

- 1-2½" x 1½" rectangle

### Flag Pole

- 1-¾" x 2½" rectangle

### Bird Appliqué

- 1-beak
- 1-body
- 1-tail
- 1-wing
- 1-eye

### Background

- 1-15½" x 2" rectangle
- 1-13" x 2" rectangle
- 1-8½" square  
cut in half once on the diagonal to make 2 half-square triangles
- 1-2½" x 8" rectangle
- 1-2½" x 4¼" rectangle
- 1-2½" x 2" rectangle
- 1-1½" square



# Be My Neighbor

Block 3 is 15" x 18" finished.

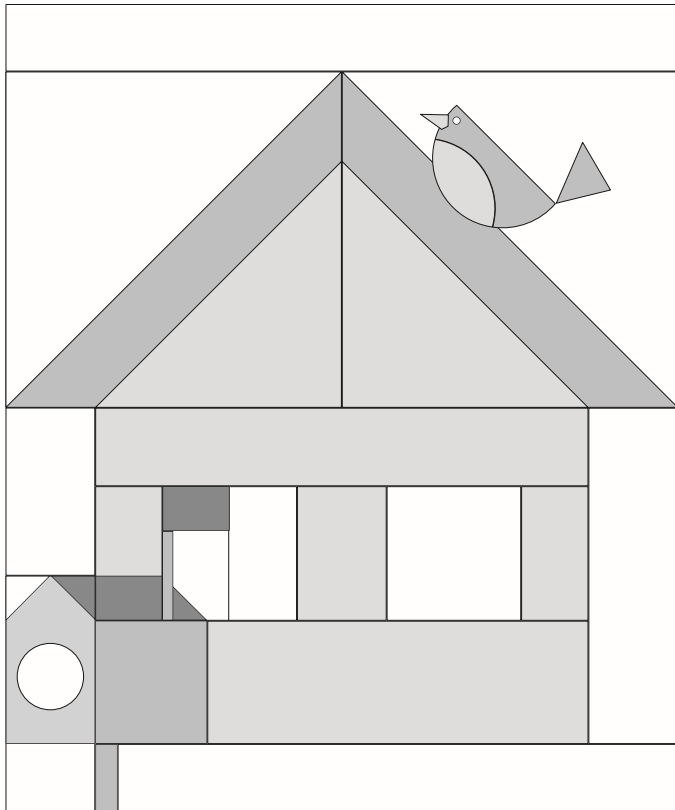

## Construction

Use 1/4" seams. Press in the direction of the arrows in the diagrams.

### 1 House Roof

(A) Join one 8 1/2" roof and one 8 1/2" background half-square triangle to make one half-triangle square (HTS). Make 2. Trim to 8".

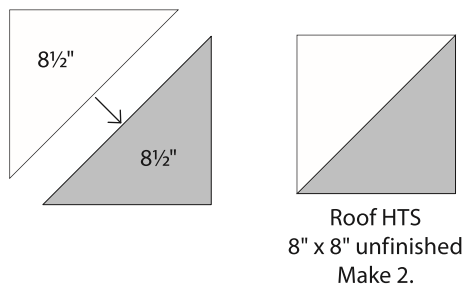

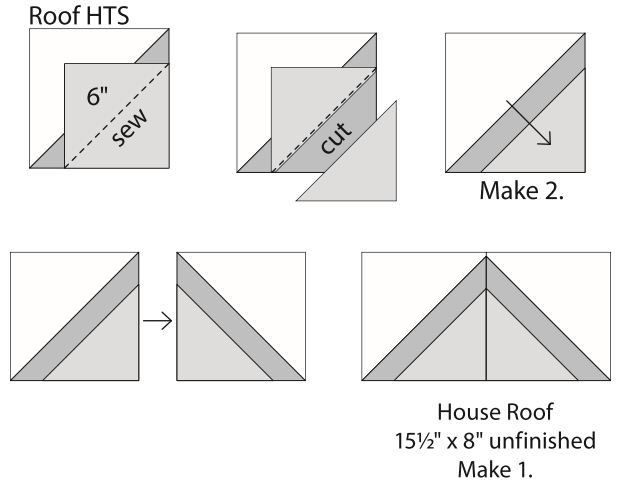

house roof continued . . .

(B) Draw a diagonal line from corner to corner on the wrong side of 2-6" house squares. Layer a marked house square, right sides to together, on a roof HTS as shown. Sew on the diagonal line. Trim the 6" house square only, 1/4" from the diagonal line. Press to reveal the triangle. Make 2. Join to make the house roof.

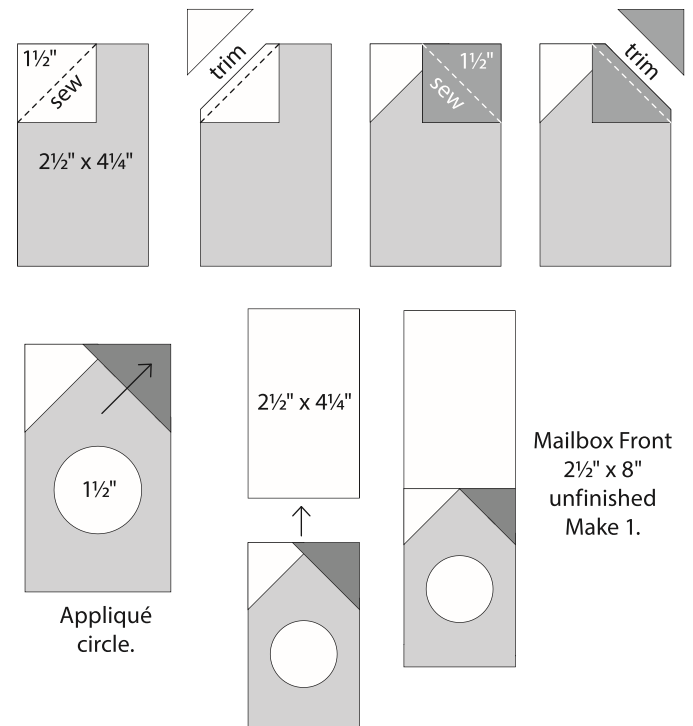

### 2 Mailbox

Draw a diagonal line from corner to corner on the wrong side of 1-1/2" background and 1-1/2" mailbox roof squares. Layer a marked background square, right sides to together, on the 2 1/2" x 4 1/4" mailbox front as shown. Sew on the diagonal line. Trim 1/4" from the diagonal line. Press to reveal the triangle. Repeat using the marked 1 1/2" mailbox square on the opposite corner as shown. Appliqué the circle to the front. Add a 2 1/2" x 4 1/4" background rectangle as shown.



### 3 Mailbox Flag and House Windows

Draw a diagonal line from corner to corner on the wrong side of 1-1/4" mailbox roof square. Layer the marked square, right sides to together, on the 1 3/4" x 2 1/2" window as shown. Sew on the diagonal line. Trim 1/4" from the diagonal line. Press to reveal the triangle.

Follow the steps to assemble the mailbox flag and house windows.

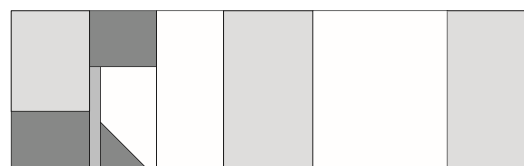
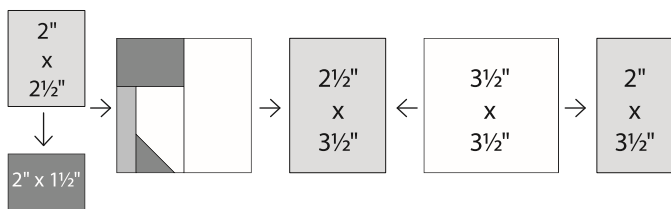
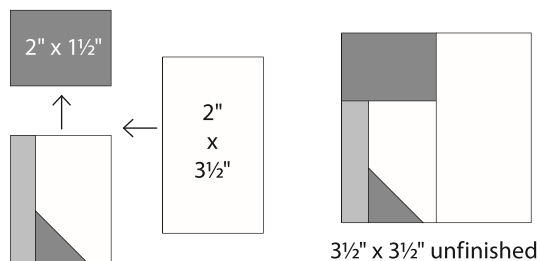
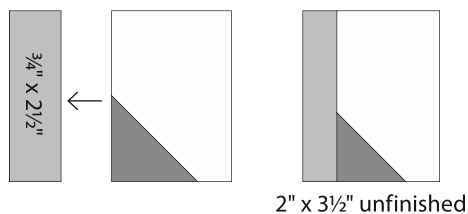
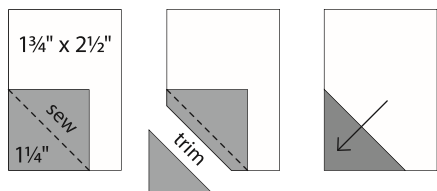

Mailbox Flag and House Windows  
1 1/2" x 3 1/2" unfinished

### 4 Assemble the block.

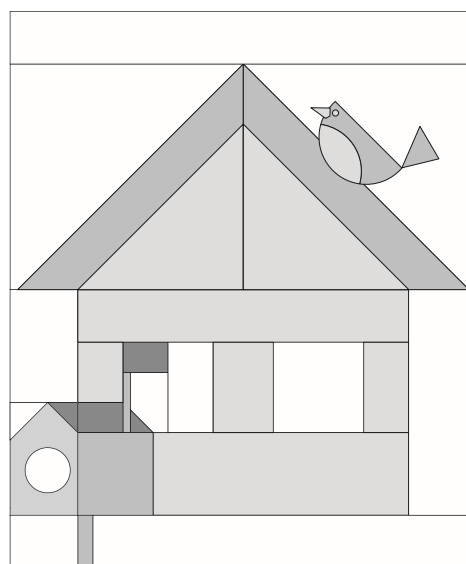
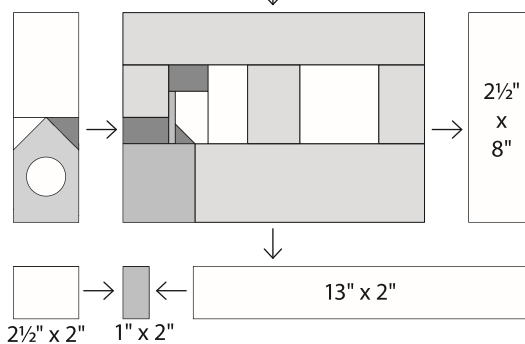
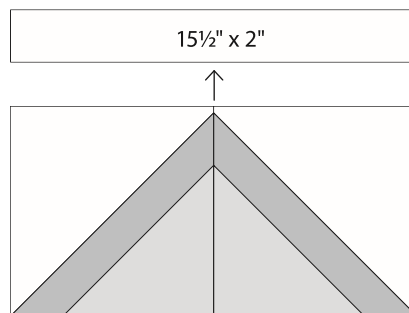
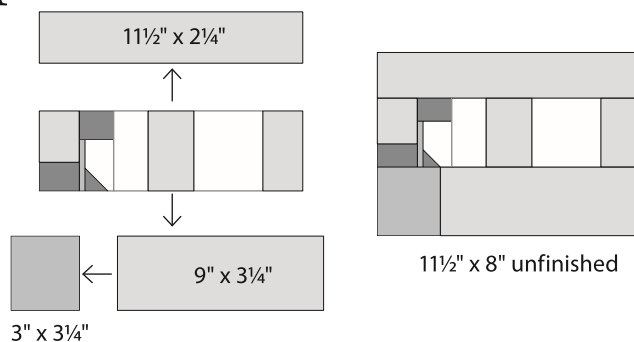

Block 3  
15 1/2" x 18 1/2" unfinished



*moda*

# Be My Neighbor

## Block 4

12" x 18" finished

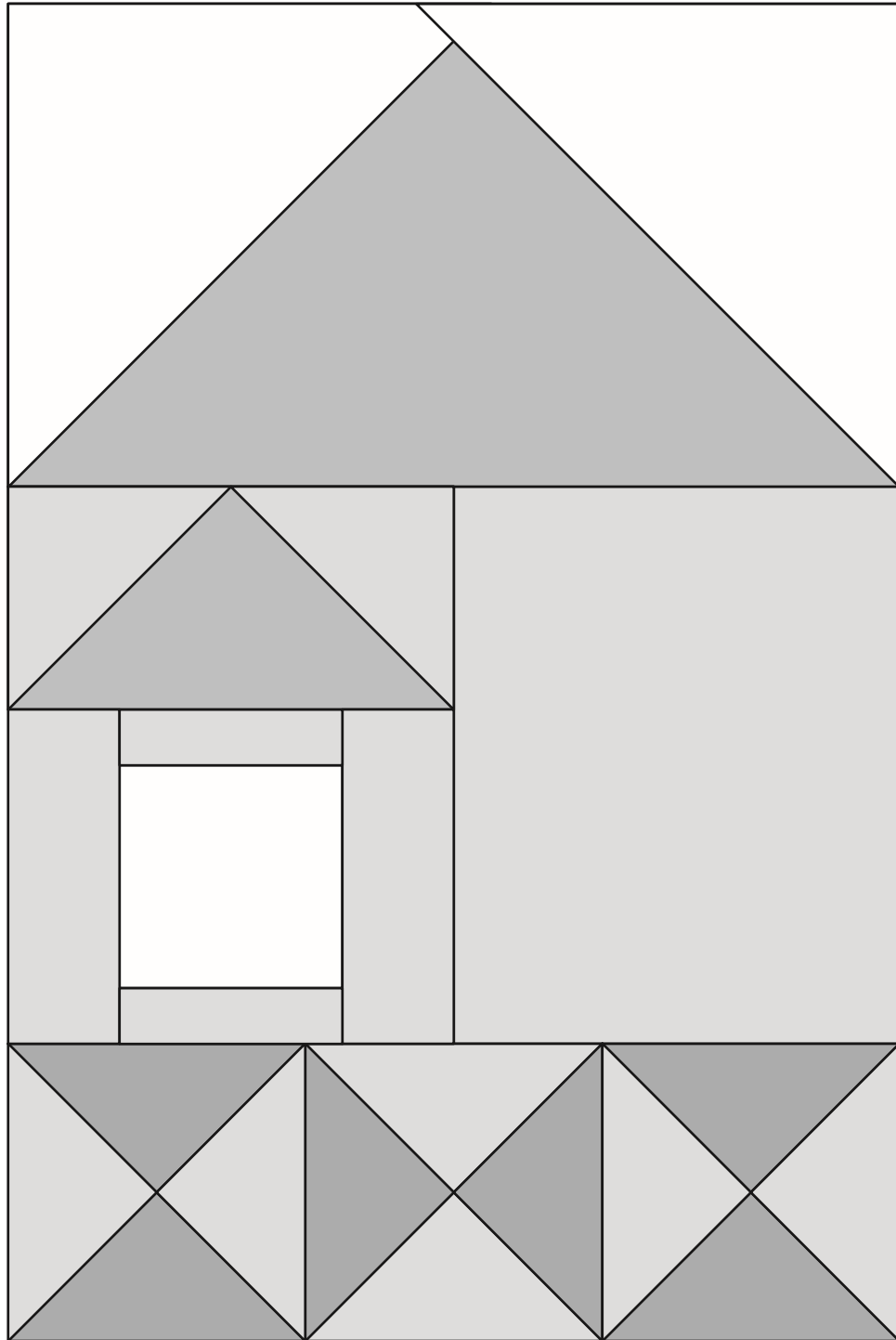

## General Information

---

- These are very scrappy blocks. Mix your favorite Moda prints to create your colorful neighborhood!
- Share your progress and final quilt at #BeMyNeighbor. We love to see your results!!!

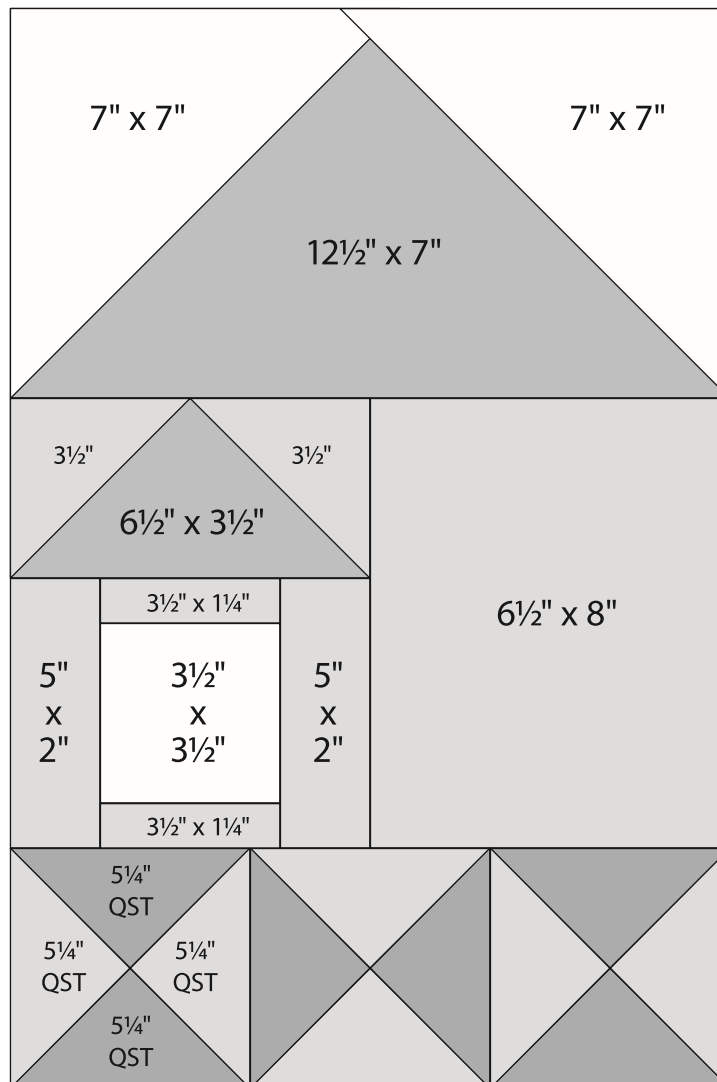

**Block 4**  
12½" x 18½" unfinished

## Cutting

---

### House Roof Large

1–12½" x 7" rectangle

### House Roof Small

1–6½" x 3½" rectangle

### Quarter-Square Triangles

2–5¼" squares

cut in half twice on the diagonal to  
make 8 quarter-square triangles (need 6)

### House

1–6½" x 8" rectangle

2–5¼" squares

cut in half twice on the diagonal to  
make 8 quarter-square triangles (need 6)

2–5" x 2" rectangles

2–3½" squares

2–3½" x 1¼" rectangles

### Window

1–3½" square

### Background

2–7" squares



# Be My Neighbor

Block 4 is 12" x 18" finished.

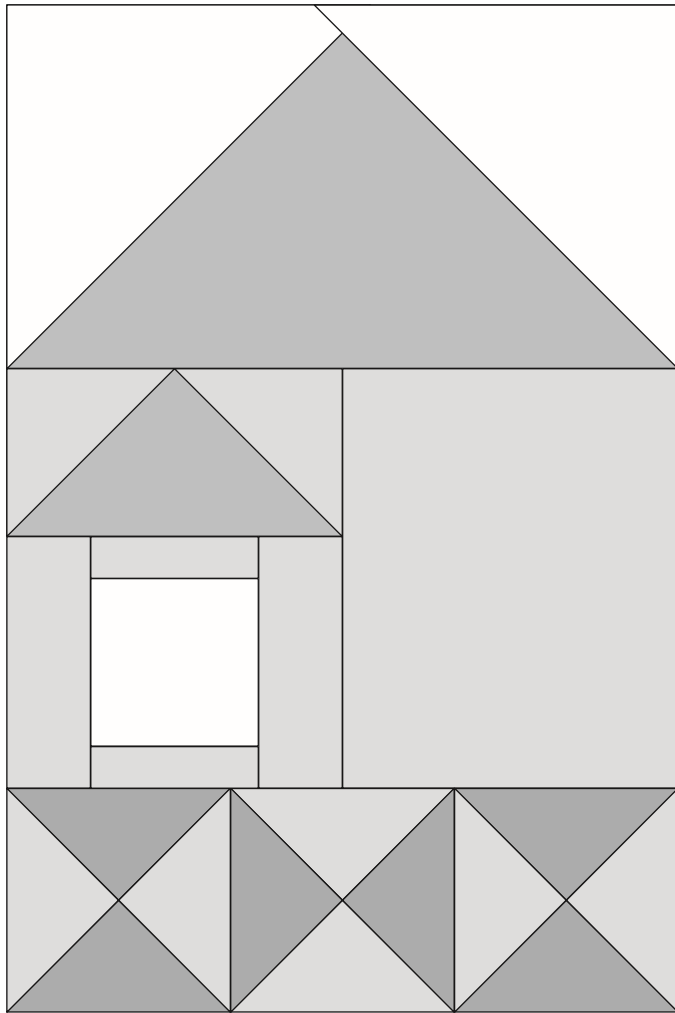

*moda*

## Construction

Use  $\frac{1}{4}$ " seams. Press in the direction of the arrows in the diagrams.

### 1 House Roof Large

Draw a diagonal line from corner to corner on the wrong side of 2-7" background squares. Layer a 7" marked background square, right sides to together, on 1-12½" x 7" large roof rectangle as shown. Sew on the diagonal line. Trim  $\frac{1}{4}$ " from the sewn line. Press to reveal the triangle. Repeat on the the opposite end of the same rectangle. Make 1.

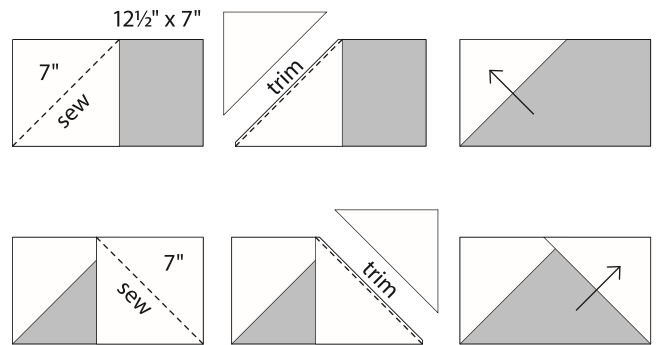

House Roof Large  
12½" x 7" unfinished  
Make 1.

### 2 House Roof Small

Draw a diagonal line from corner to corner on the wrong side of 2-3½" house squares. Layer a 3½" marked house square, right sides to together, on 1-6½" x 3½" small roof rectangle as shown. Sew on the diagonal line. Trim  $\frac{1}{4}$ " from the sewn line. Press to reveal the triangle. Repeat on the the opposite end of the same rectangle. Make 1.

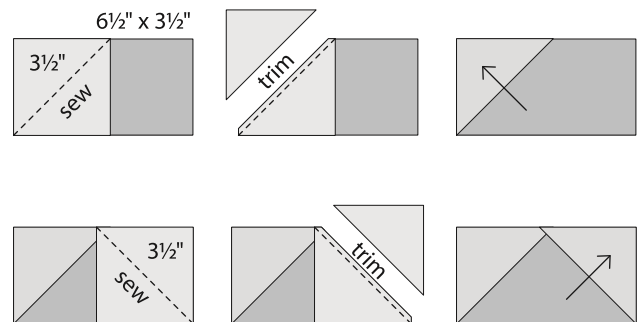

House Roof Small  
6½" x 3½" unfinished  
Make 1.

3 Assemble the window section as shown.

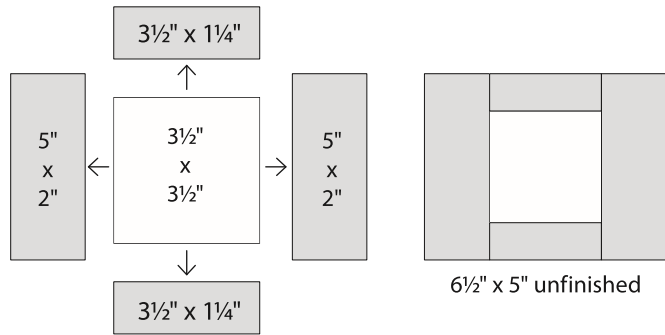

House Roof Small

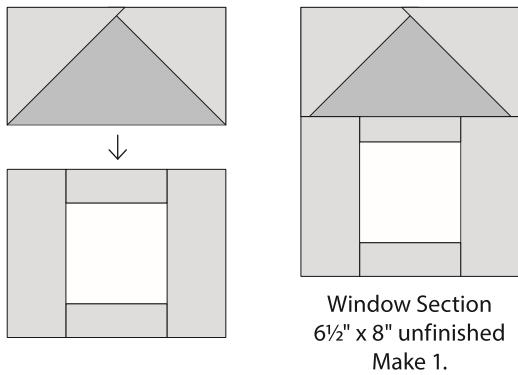

4 House Base

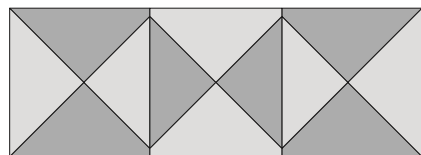
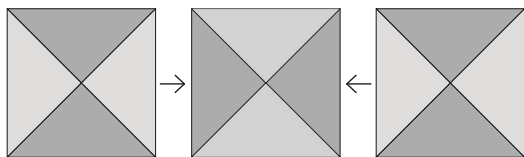
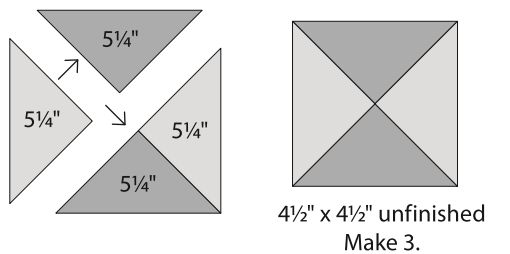

5 Assemble the block as shown.

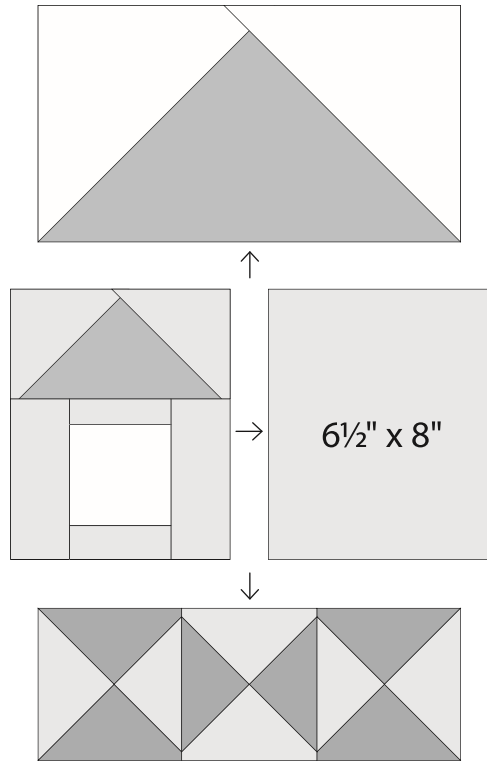

*moda*

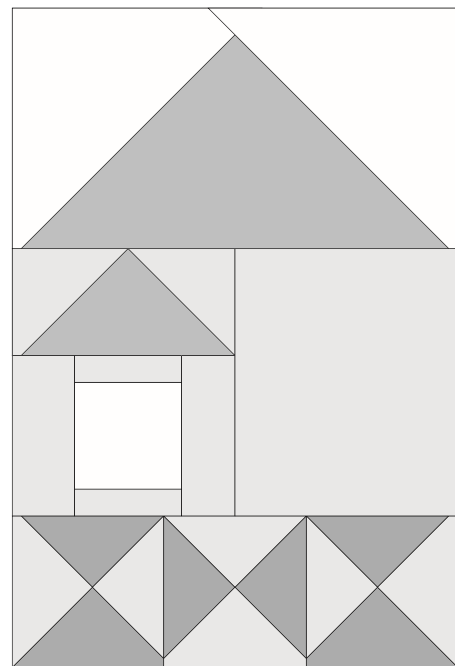





*moda*

# Be My Neighbor

## Block 5

12" x 18" finished

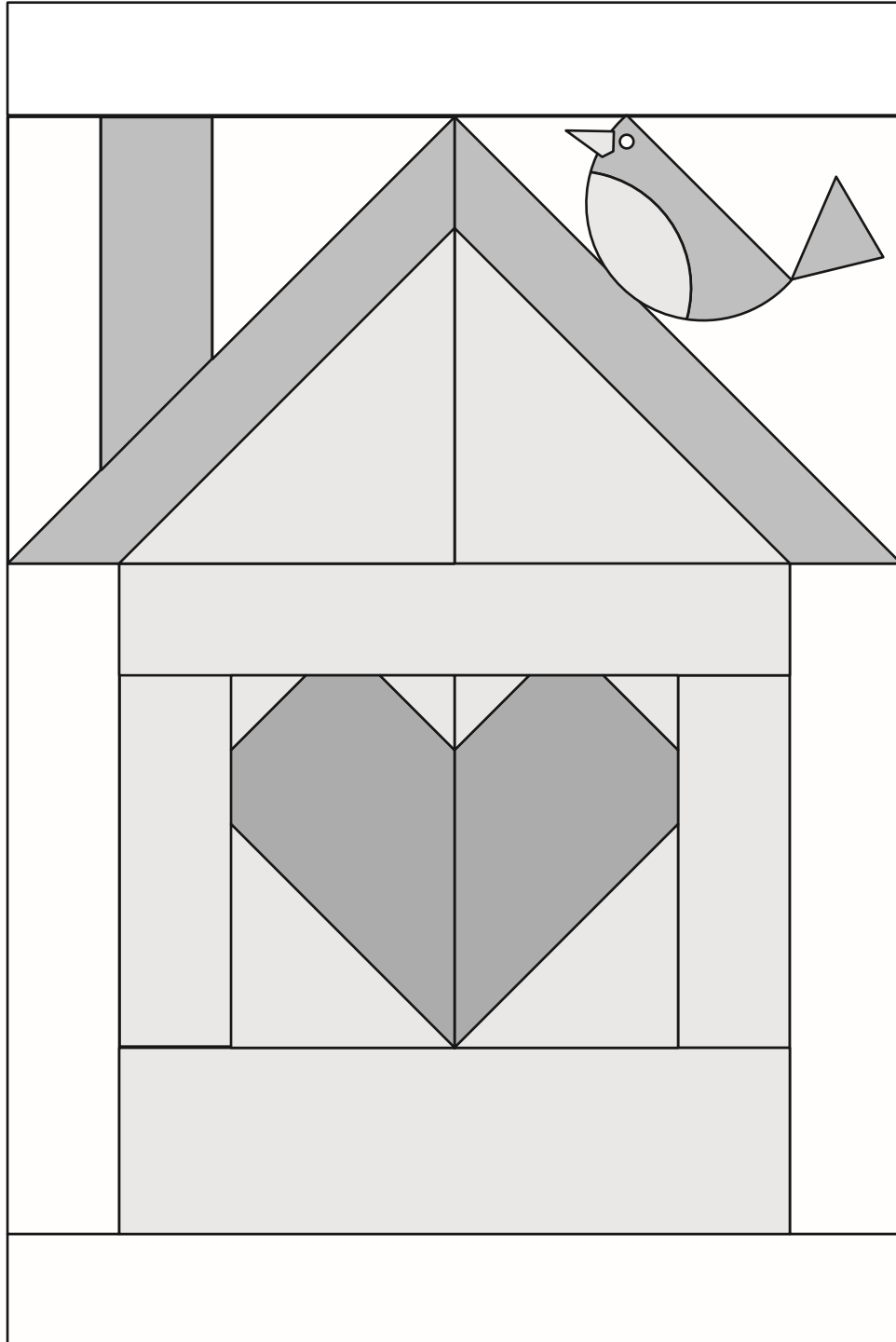

## General Information

- These are very scrappy blocks. Mix your favorite Moda prints to create your colorful neighborhood!
- Share your progress and final quilt at #BeMyNeighbor. We love to see your results!!!

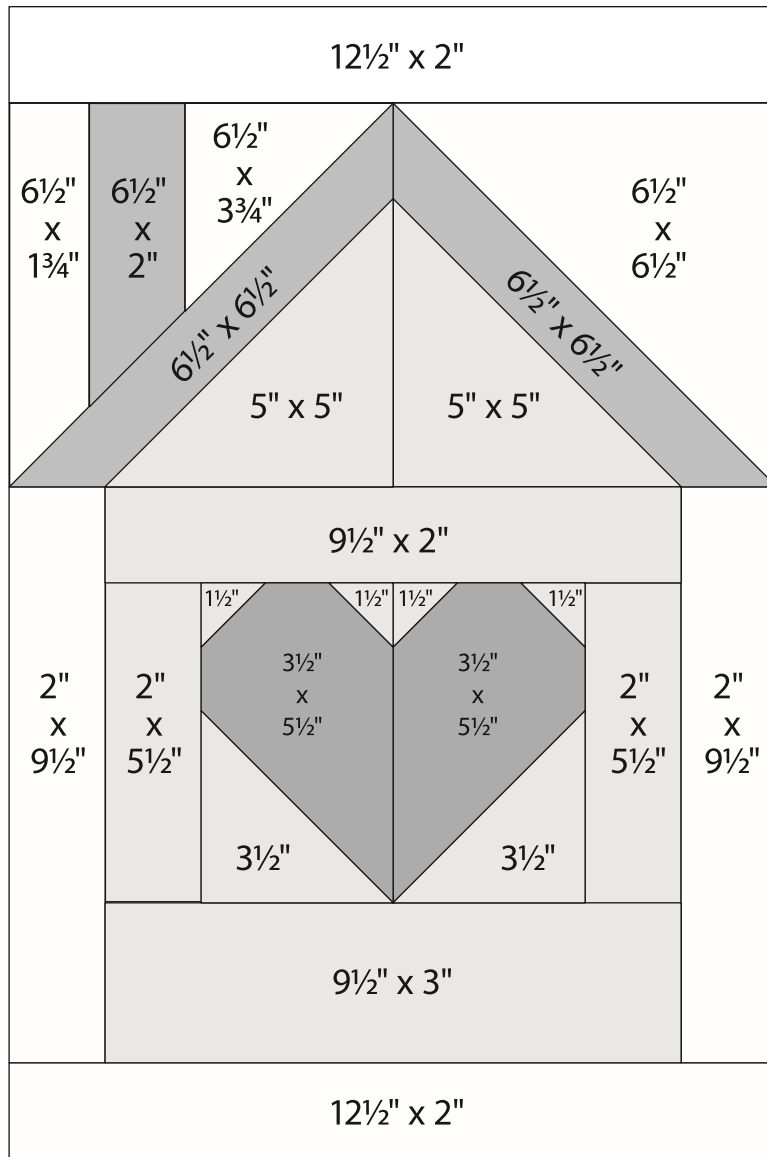

**Block 5**  
12½" x 18½" unfinished

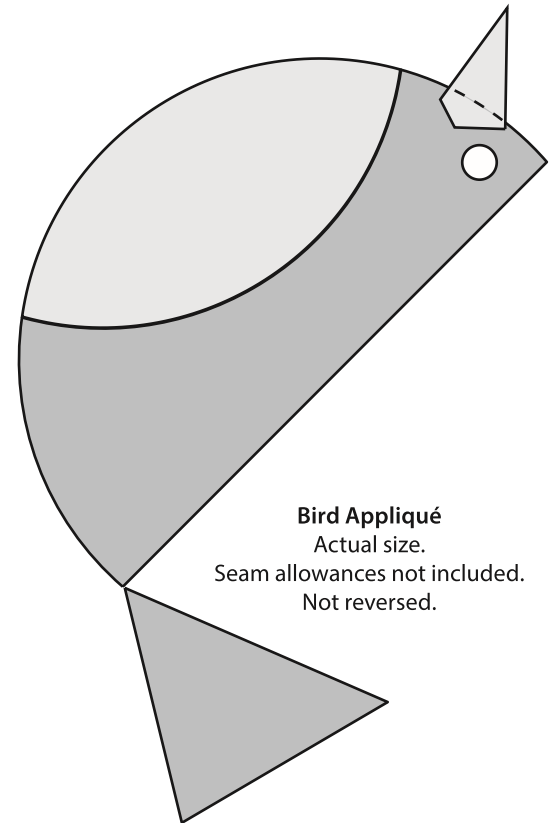

**Bird Appliqué**  
Actual size.  
Seam allowances not included.  
Not reversed.

## Cutting

### House

- 1–9½" x 3" rectangles
- 1–9½" x 2" rectangles
- 2–5½" x 2" rectangles
- 2–5" squares
- 2–3½" squares
- 4–1½" squares

### Roof: 2–6½" squares

### Chimney: 1–2" x 6½"

### Heart: 2–3½" x 5½"

### Background

- 1–6½" square
- 1–6½" x 3¾" rectangle
- 1–6½" x 1¾" rectangle
- 2–2" x 12½" rectangles
- 2–2" x 9½" rectangles

### Bird Appliqué

- 1–beak
- 1–body
- 1–tail
- 1–wing
- 1–eye



# moda Be My Neighbor

Block 5 is 12" x 18" finished.

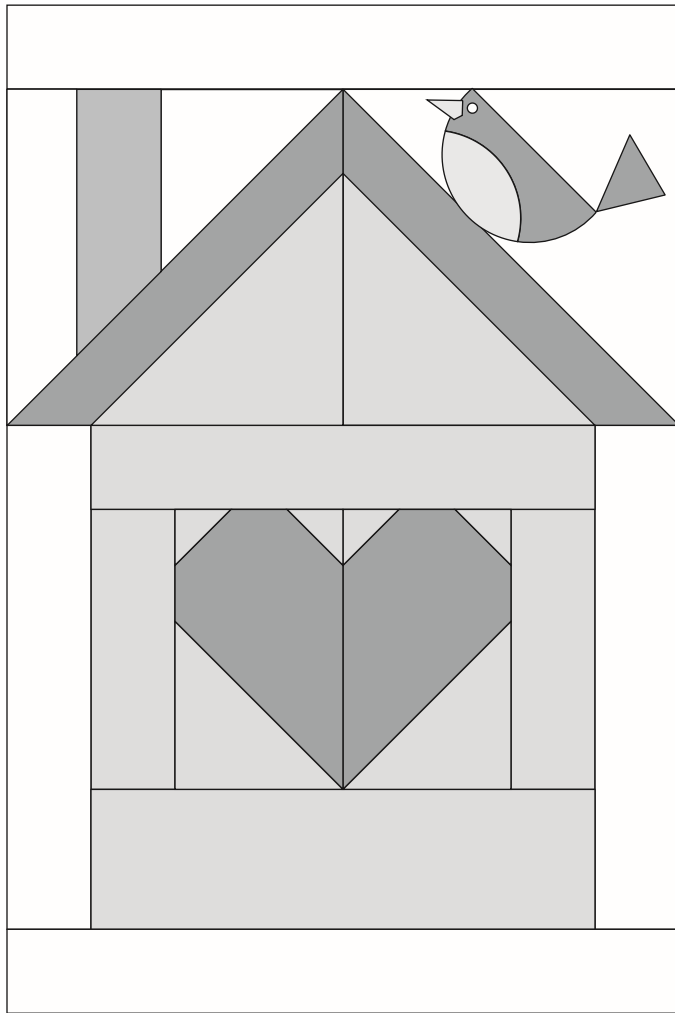

## Construction

Use  $\frac{1}{4}$ " seams. Press in the direction of the arrows in the diagrams.

### 1 Roof

- (A) Join a  $1\frac{3}{4}$ " x  $6\frac{1}{2}$ " background, 2" x  $6\frac{1}{2}$ " chimney, and  $3\frac{3}{4}$ " x  $6\frac{1}{2}$ " background strip as shown.

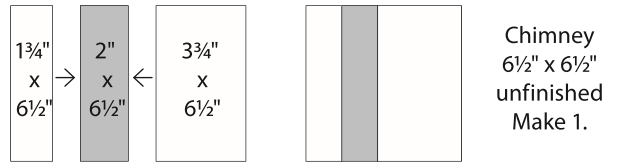

- (B) Draw a diagonal line from corner to corner on the wrong side of 2–5" house squares. Layer a 5" marked background square, right sides to together, on 1– $6\frac{1}{2}$ " roof square as shown. Sew on the diagonal line. Trim  $\frac{1}{4}$ " from the sewn line. Press to reveal the triangle. Make 2.

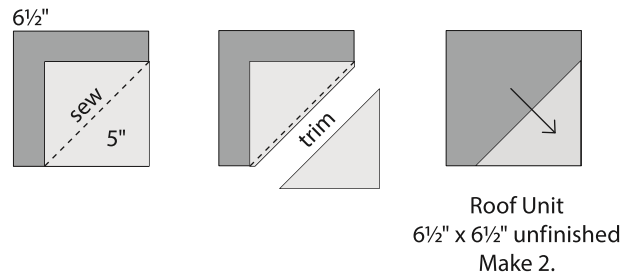

- (C) Draw a diagonal line from corner to corner on the wrong side of the chimney as shown. Layer the marked chimney, right sides together, on a roof unit as shown. Sew, trim, and press. Make 1.

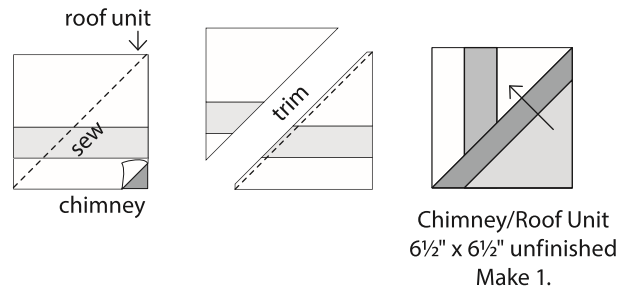

moda

(D) Draw a diagonal line from corner to corner on the wrong side of a 6½" background square. Layer the marked square, right sides together, on a roof unit as shown. Sew, trim, and press to reveal the triangle. Make 1. Join units to make the roof.

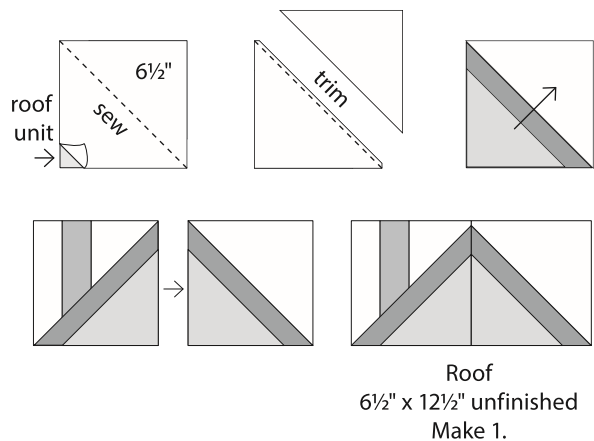

**2 Heart** Draw a diagonal line from corner to corner on the wrong side of 2–3½" house squares, and 4–1½" house squares. Layer, sew, trim, and press as shown on 2–3½" x 5½" hearts. Join the 2 sides to make the heart.

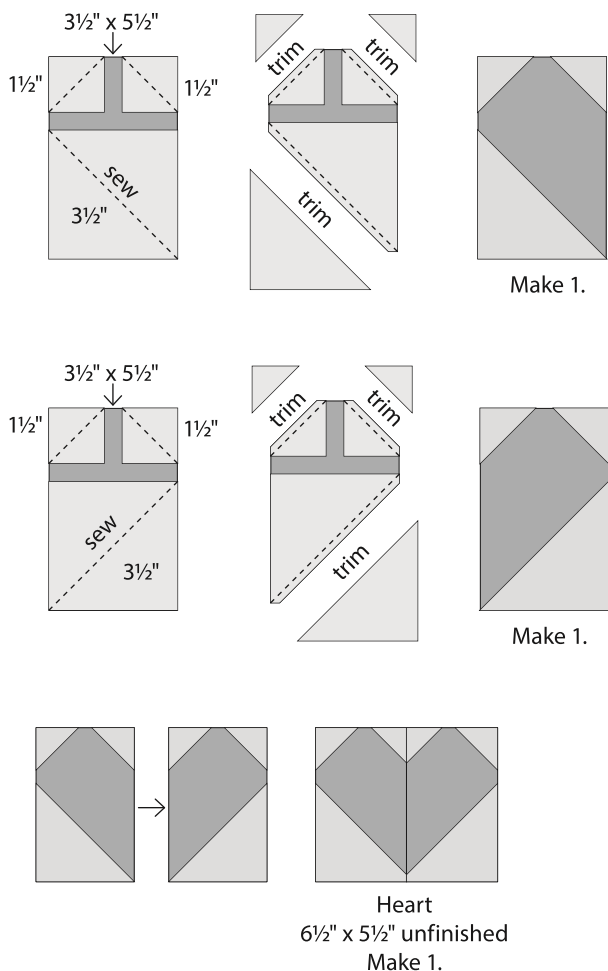

**3 House assembly** Assemble the heart house as shown. Use fusible web and a zig zag or blanket stitch to add the bird to the completed house block.

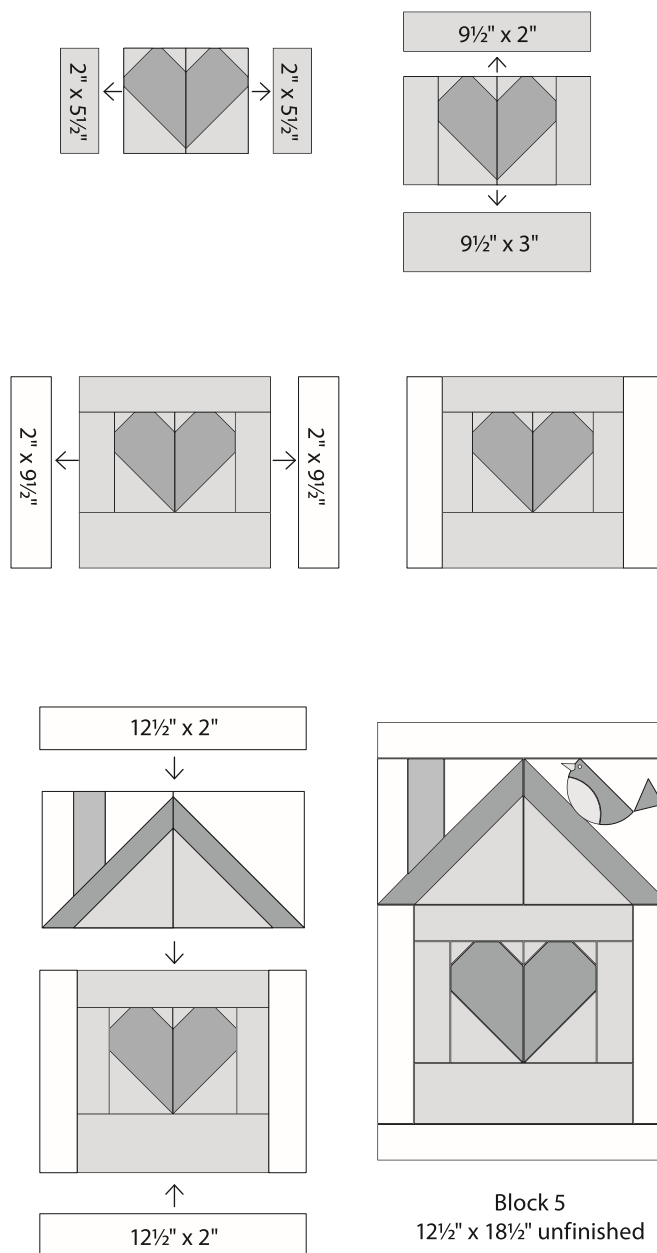

*moda*



*moda*

# Be My Neighbor

## Block 6

18" x 18" finished

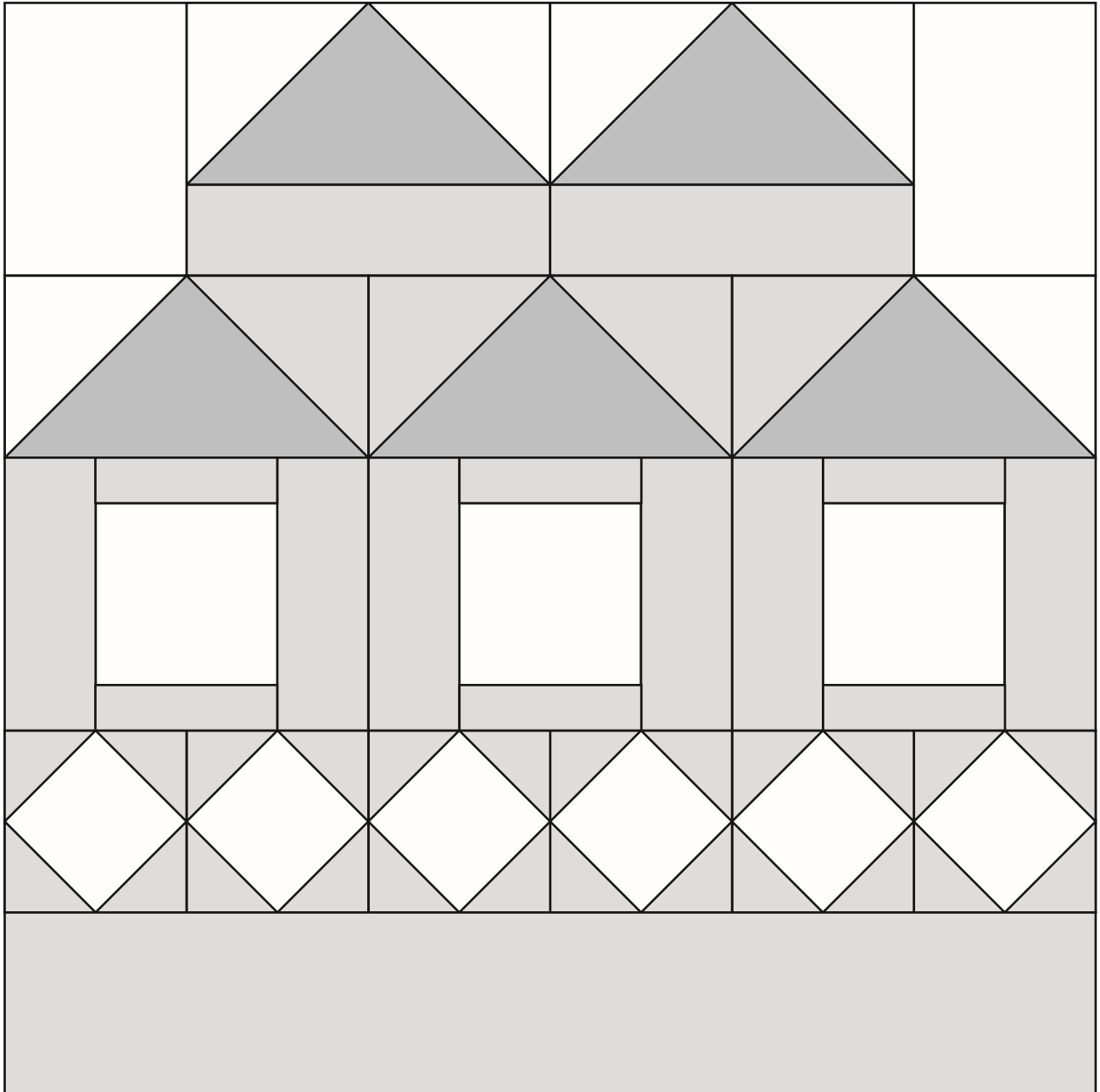

## General Information

- These are very scrappy blocks. Mix your favorite Moda prints to create your colorful neighborhood!
- Share your progress and final quilt at #BeMyNeighbor. We love to see your results!!!

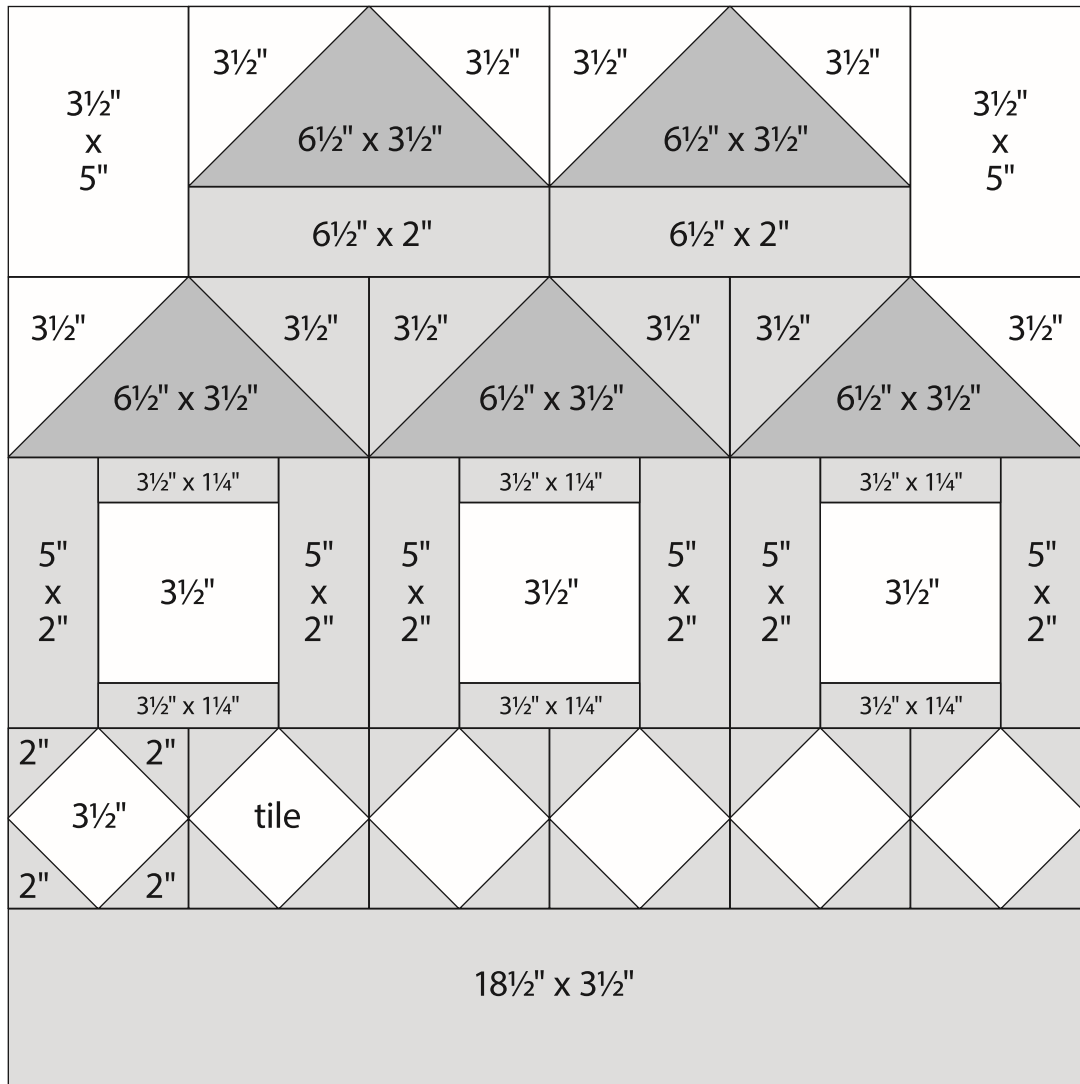

**Block 6**  
18½" x 18½" unfinished

## Cutting

### House Rooftops

5–6½" x 3½" rectangles

### Tiles

6–3½" squares

### Windows

3–3½" squares

### House

1–18½" x 3½" rectangle

2–6½" x 2" rectangles

6–5" x 2" rectangles

4–3½" squares

6–3½" x 1¼" rectangles

24–2" squares

### Background

2–3½" x 5" rectangles

6–3½" squares

# Be My Neighbor

Block 6 is 18" x 18" finished.

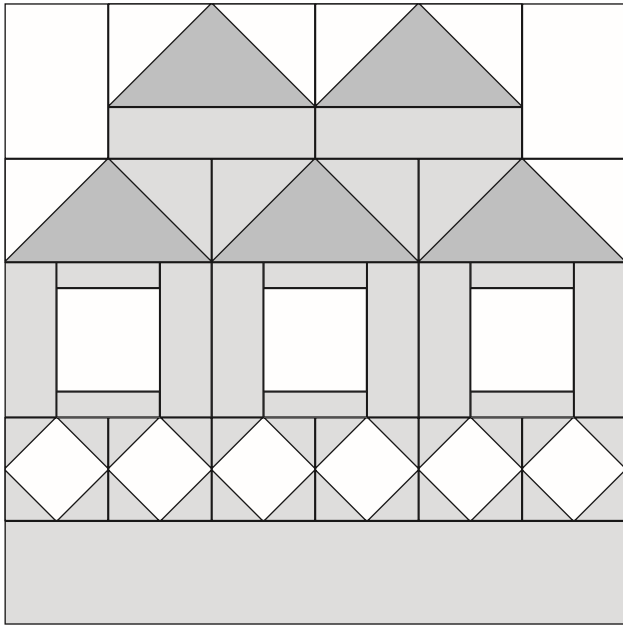

## Construction

Use  $\frac{1}{4}$ " seams. Press in the direction of the arrows in the diagrams.

### 1 House Rooftops A, B, C, and D

Draw a diagonal line from corner to corner on the wrong side of  $4-3\frac{1}{2}$ " house squares and  $6-3\frac{1}{2}$ " background squares.

The same technique is used to make all the roof tops. Just note whether you are using a marked house or marked background square. Layer a marked square, right sides to together, on  $1-6\frac{1}{2}$ " x  $3\frac{1}{2}$ " roof rectangle as shown. Sew on the diagonal line. Trim  $\frac{1}{4}$ " from the sewn line. Press to reveal the triangle. Repeat on the opposite end of the same rectangle.

#### House Roof A

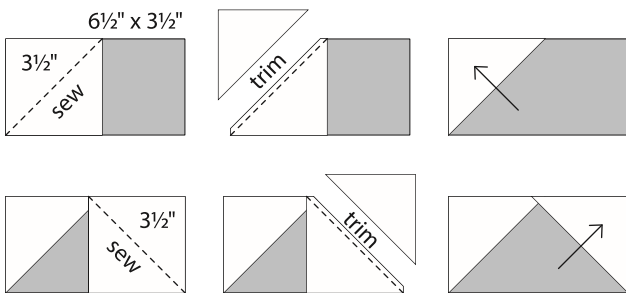

House Roof A  
 $6\frac{1}{2}$ " x  $3\frac{1}{2}$ " unfinished  
Make 2.

house roof tops continued . . .

#### House Roof B

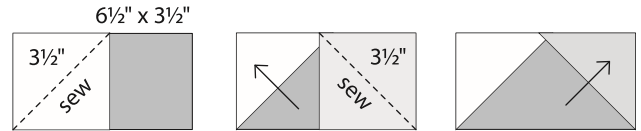

House Roof B  
 $6\frac{1}{2}$ " x  $3\frac{1}{2}$ " unfinished  
Make 1.

#### House Roof C

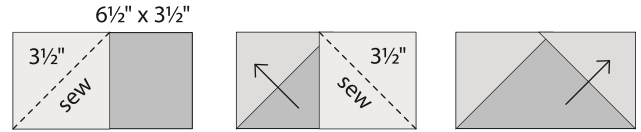

House Roof C  
 $6\frac{1}{2}$ " x  $3\frac{1}{2}$ " unfinished  
Make 1.

#### House Roof D

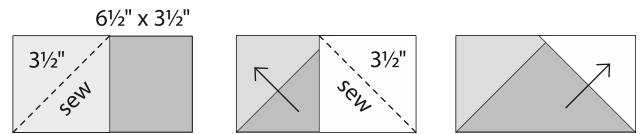

House Roof D  
 $6\frac{1}{2}$ " x  $3\frac{1}{2}$ " unfinished  
Make 1.

### 2 Assemble windows and rooftops as shown.

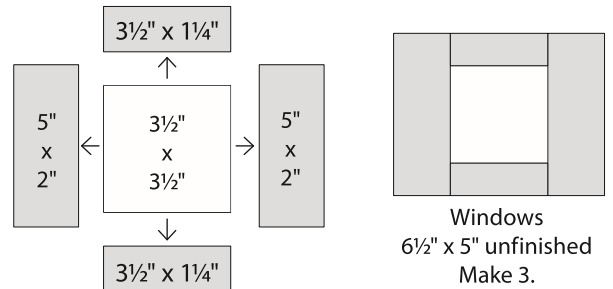

Windows  
 $6\frac{1}{2}$ " x 5" unfinished  
Make 3.

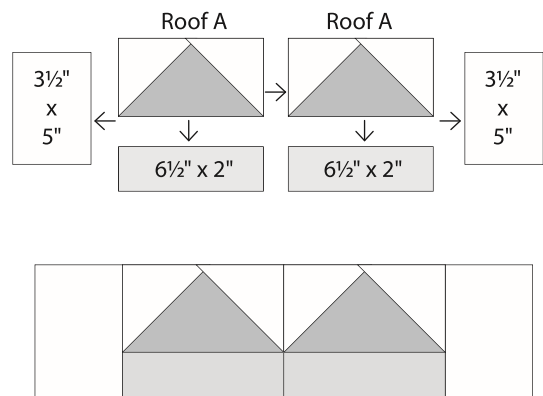

$18\frac{1}{2}$ " x 5" unfinished

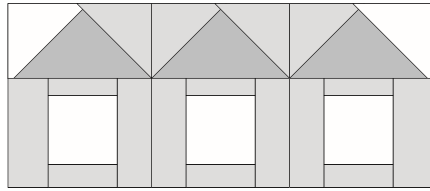
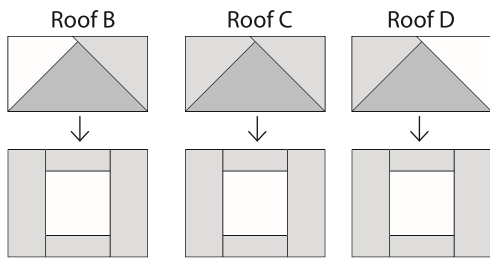

18½" x 8" unfinished

### 3 House Tiles

Draw a diagonal line from corner to corner on the wrong side of 24–2" house squares. Layer 2 marked squares on opposite corners of a 3" tile square, right sides to together. Sew on the diagonal lines. Trim ¼" from the sewn line. Press to reveal the triangles. Repeat on the opposite ends of the same square. Make 6.

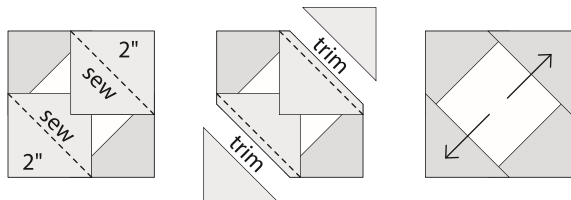
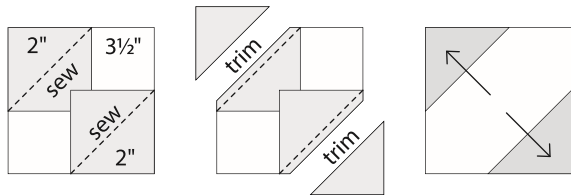

3½" x 3½" unfinished  
Make 6.

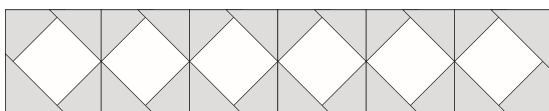
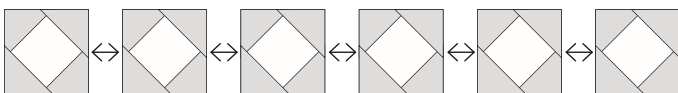

Tiles  
18½" x 3½" unfinished  
Make 1.

### 4 Assemble the block as shown.

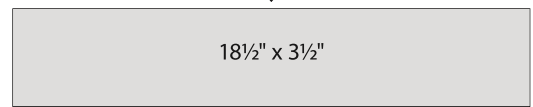
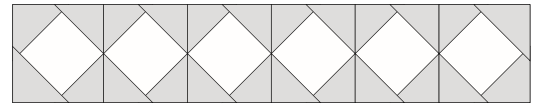
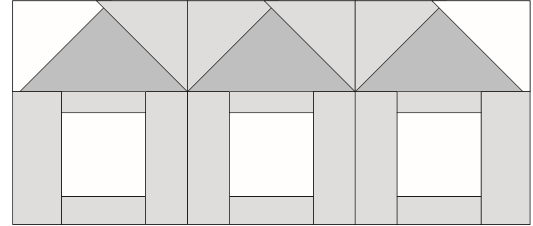
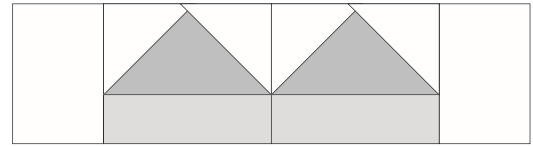

*moda*

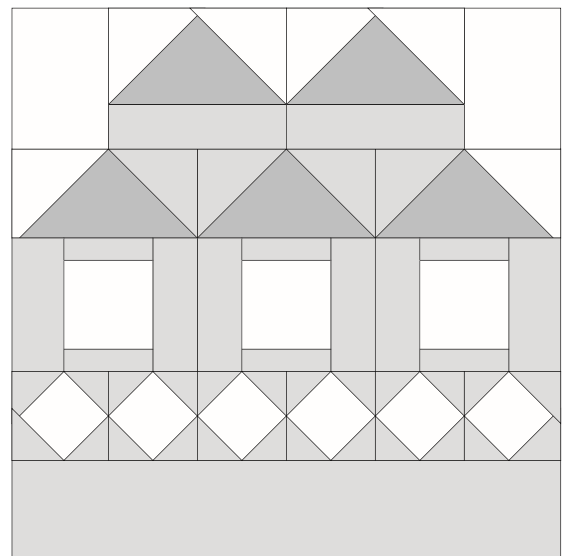

Block 6  
18½" x 18½" unfinished





*moda*

# Be My Neighbor

**Block 7**  
15" x 18" finished

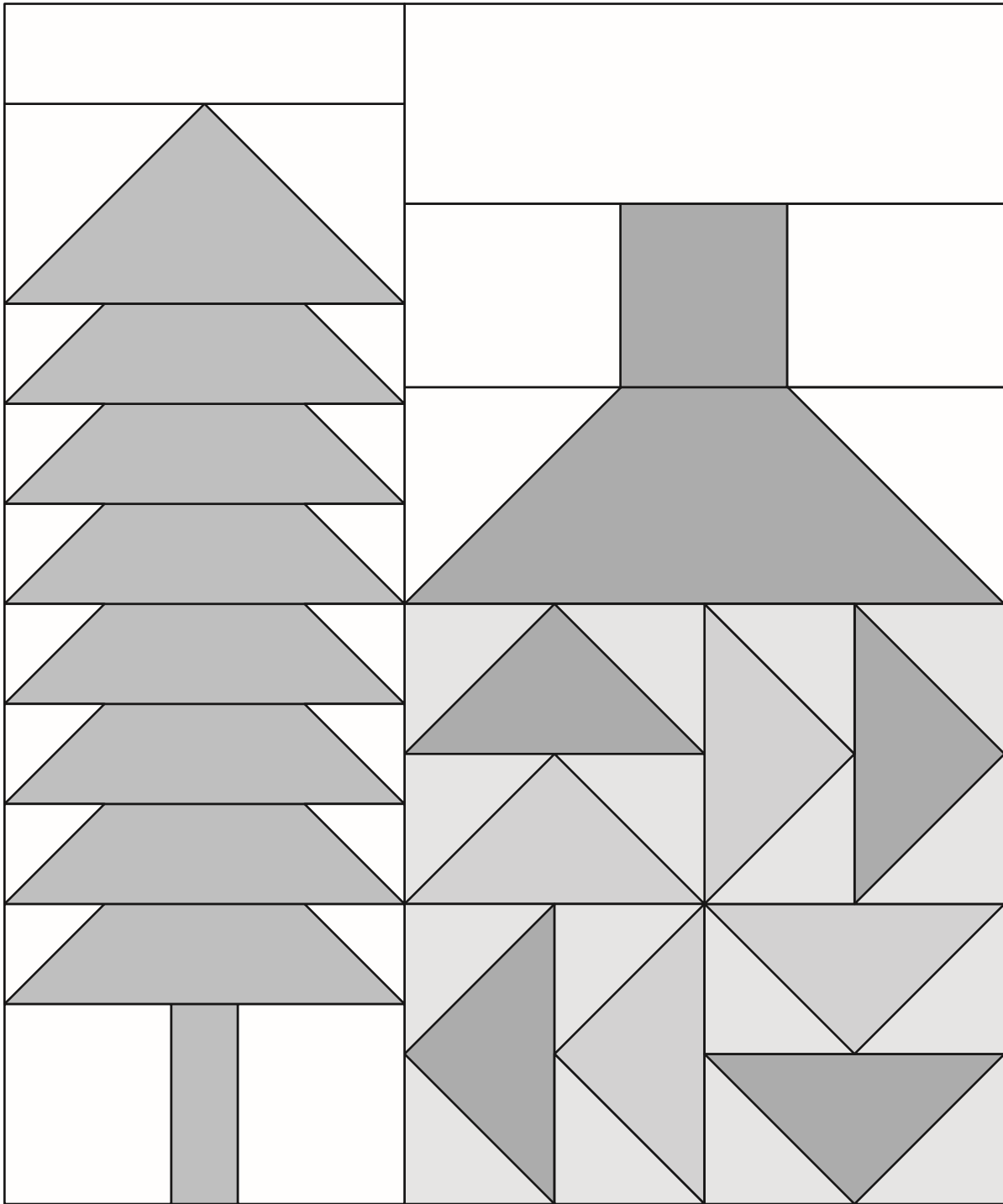

## General Information

- These are very scrappy blocks. Mix your favorite Moda prints to create your colorful neighborhood!
- Share your progress and final quilt at #BeMyNeighbor. We love to see your results!!!

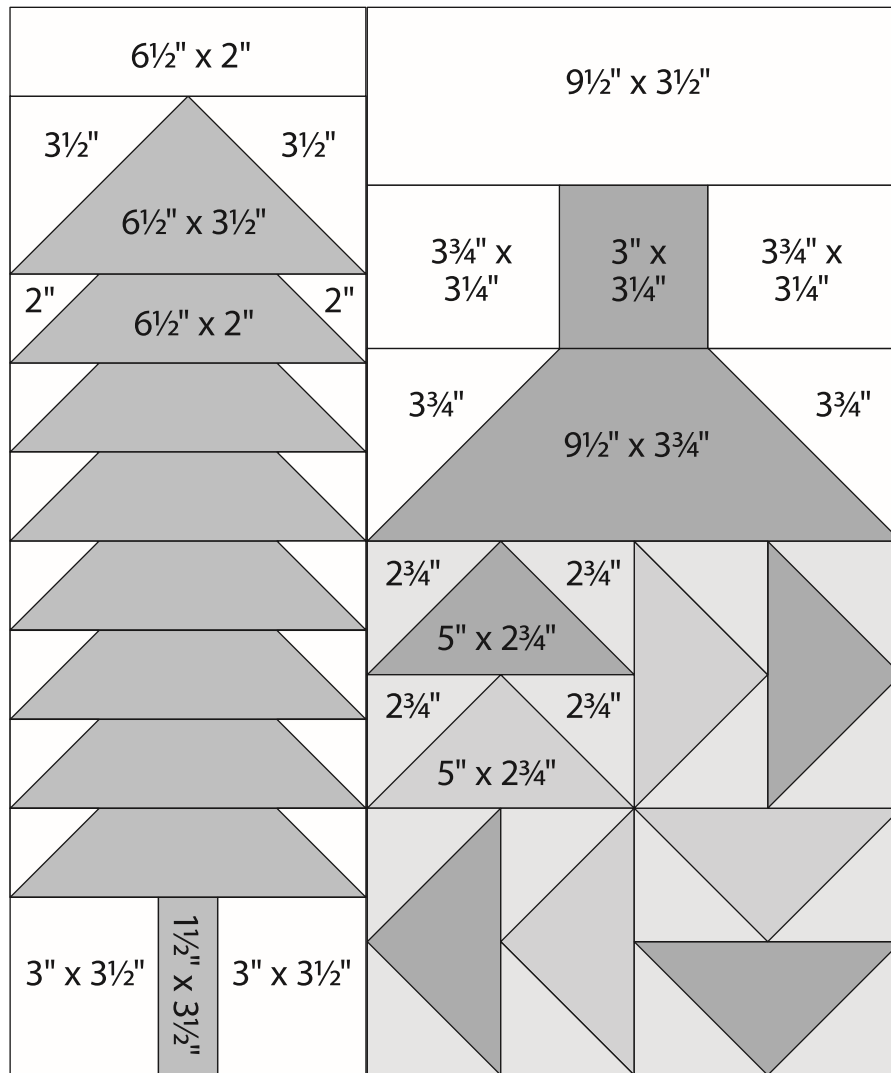

**Block 7**  
15 1/2" x 18 1/2" unfinished

## Cutting

### Tree

- 1-6 1/2" x 3 1/2" rectangle
- 7-6 1/2" x 2" rectangles

### Tree Trunk

- 1-1 1/2" x 3 1/2" rectangle

### House Roof and Chimney

- 1-9 1/2" x 3 3/4" rectangle
- 1-3" x 3 1/4" rectangle

### House

- 16-2 3/4" squares

### Flying Geese Dark

- 4-5" x 2 3/4" rectangles

### Flying Geese Medium

- 4-5" x 2 3/4" rectangles

### Background

- 1-9 1/2" x 3 1/2" rectangle
- 1-6 1/2" x 2" rectangle
- 2-3 3/4" squares
- 2-3 3/4" x 3 1/4" rectangles
- 2-3 1/2" squares
- 2-3" x 3 1/2" rectangles
- 14-2" squares



# Be My Neighbor

moda

Block 7 is 15" x 18" finished.

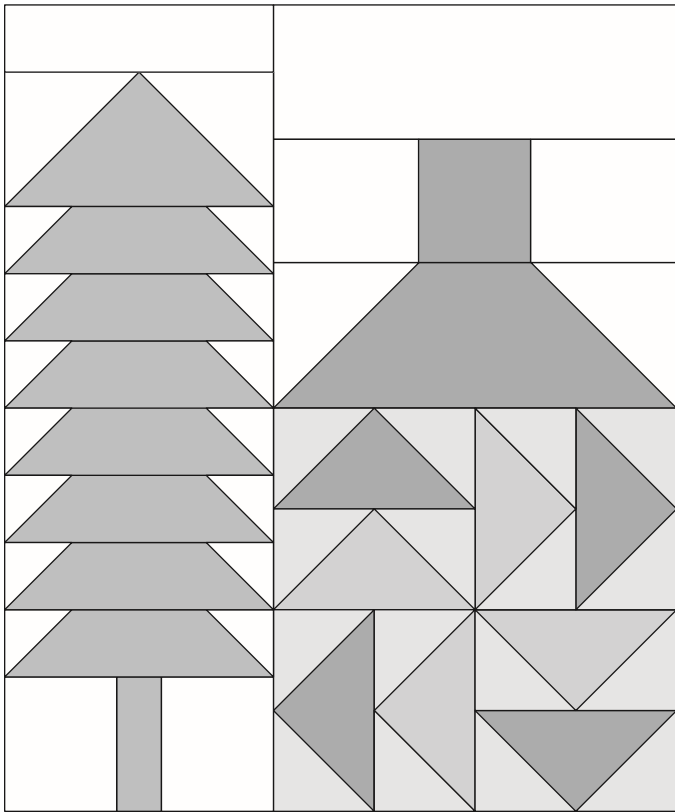

## Construction

Use  $\frac{1}{4}$ " seams. Press in the direction of the arrows in the diagrams.

### 1 House

- (A) Draw a diagonal line from corner to corner on the wrong side of  $2-3\frac{3}{4}$ " background squares. Layer a  $3\frac{3}{4}$ " marked background square, right sides together, on both ends of a  $1-9\frac{1}{2}$ " x  $3\frac{3}{4}$ " roof rectangle as shown. Sew on the diagonal lines. Trim  $\frac{1}{4}$ " from the sewn lines. Press to reveal the triangles.

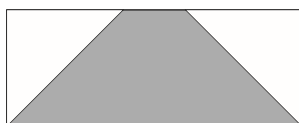
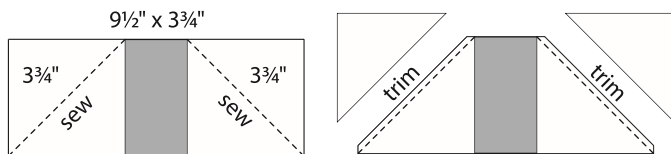

Roof  
 $9\frac{1}{2}$ " x  $3\frac{3}{4}$ " unfinished

House continued . . .

- (B) Draw a diagonal line from corner to corner on the wrong side of  $16-2\frac{3}{4}$ " house squares. Layer a  $2\frac{3}{4}$ " marked house square, right sides together, on  $1-5$ " x  $2\frac{3}{4}$ " flying geese rectangle as shown. Sew on the diagonal line. Trim  $\frac{1}{4}$ " from the sewn line. Press to reveal the triangle. Repeat on the opposite end of the same rectangle. Make 4 dark and 4 medium.

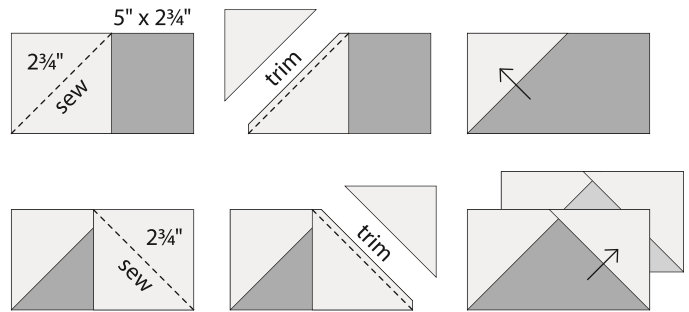

Flying Geese  
 $5$ " x  $2\frac{3}{4}$ " unfinished  
Make 4 dark and 4 medium.

- (C) Join 1 dark and medium flying geese as shown. Make 4.

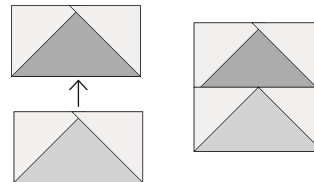

$5$ " x  $5$ " unfinished  
Make 4.

- (D) Assemble the house bottom.

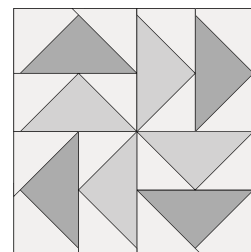
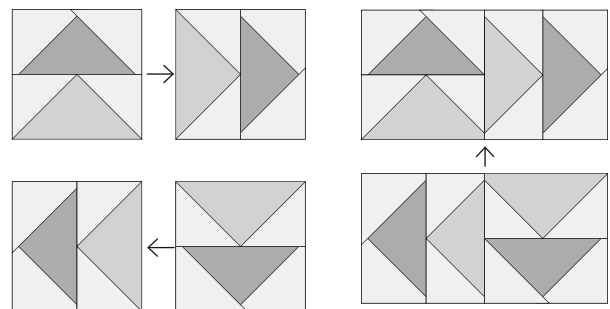

House Bottom  
 $9\frac{1}{2}$ " x  $9\frac{1}{2}$ " unfinished

moda

House continued . . .

(E) Assemble the house as shown.

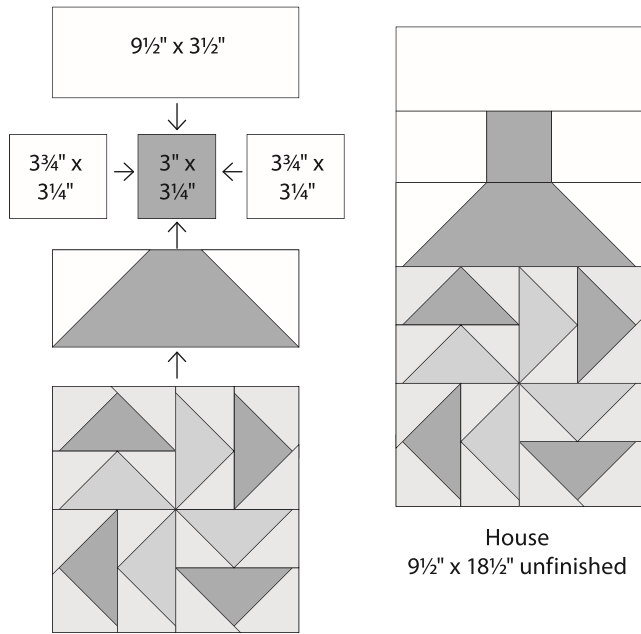

(C) Assemble the tree as shown.

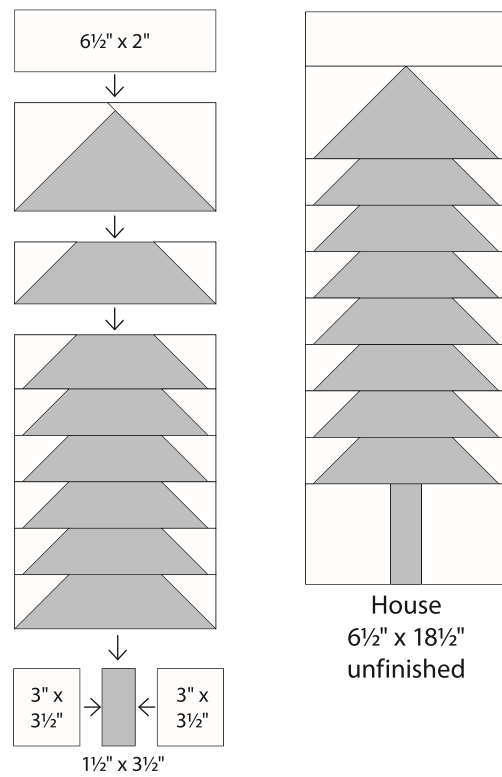

## 2 Tree

(A) Draw a diagonal line from corner to corner on the wrong side of 2–3 1/2" background squares. Layer a 3 1/2" marked background square, right sides to together, on 1–6 1/2" x 3 1/2" tree rectangle as shown. Sew on the diagonal line. Trim 1/4" from the sewn line. Press to reveal the triangle. Repeat on the opposite end of the same rectangle. Make 1.

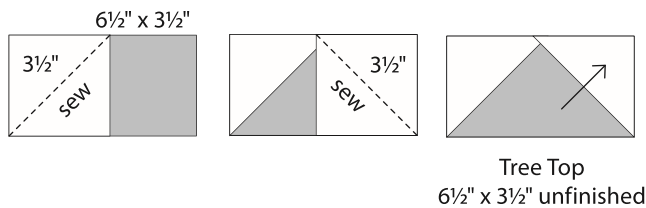

(B) Draw a diagonal line from corner to corner on the wrong side of 14–2" background squares. Layer 2" marked background square, right sides to together, on 1–6 1/2" x 2" tree rectangle as shown. Sew on the diagonal line. Trim 1/4" from the sewn line. Press to reveal the triangle. Repeat on the opposite end of the same rectangle. Make 7.

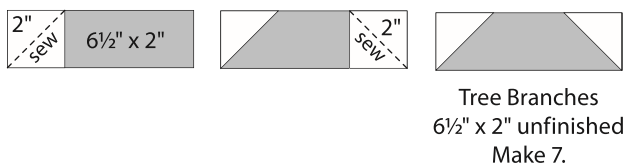

## 3 Assemble the block as shown.

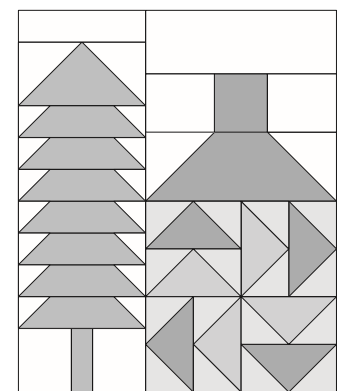
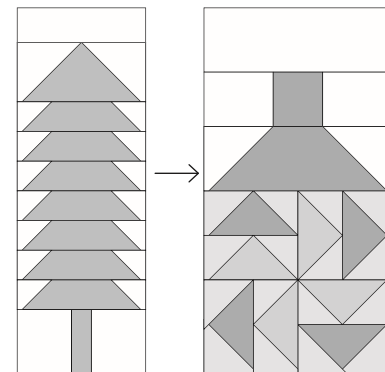

Block 7  
15 1/2" x 18 1/2" unfinished



*moda*

# Be My Neighbor

## Block 8

15" x 18" finished

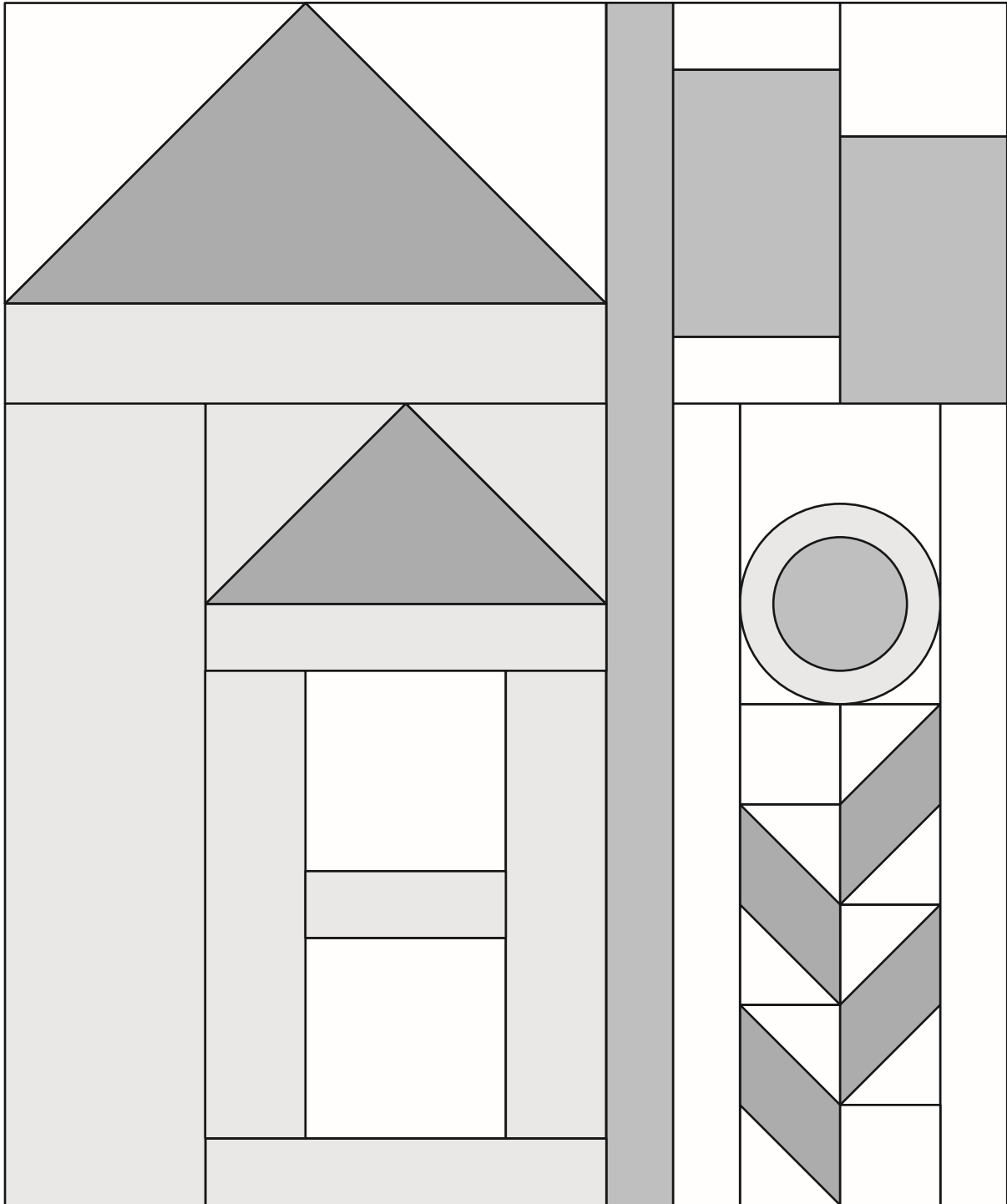

## General Information

- These are very scrappy blocks. Mix your favorite Moda prints to create your colorful neighborhood!
- Share your progress and final quilt at #BeMyNeighbor. We love to see your results!!!

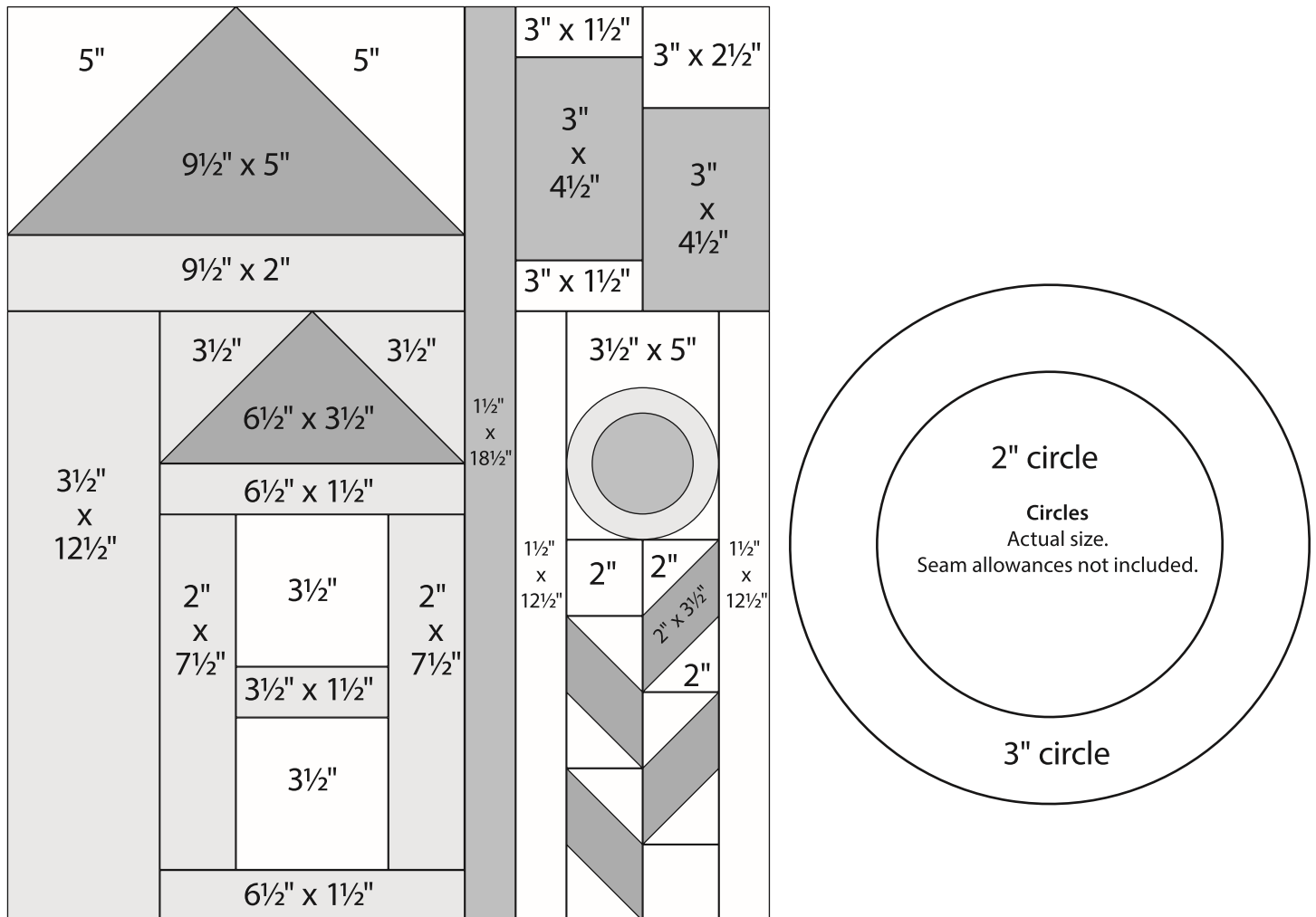

**Block 8**  
15½" x 18½" unfinished

## Cutting

### Leaves

4–2" x 3½" rectangles

### Flowers

2 circles

### Roof

1–9½" x 5" rectangle

1–6½" x 3½" rectangle

### Flag

2–3" x 4½" rectangles

### Flag Pole

1–1½" x 18½" rectangle

### Window

2–3½" squares

### House

1–9½" x 2" rectangle

2–6½" x 1½" rectangles

1–3½" x 12½" rectangle

1–3½" x 1½" rectangle

2–3½" squares

2–2" x 7½" rectangles

### Background

2–5" squares

1–3½" x 5" rectangle

2–3" x 1½" rectangles

1–3" x 2½" rectangle

10–2" squares

2–1½" x 12½" rectangles



# moda Be My Neighbor

Block 8 is 15" x 18" finished.

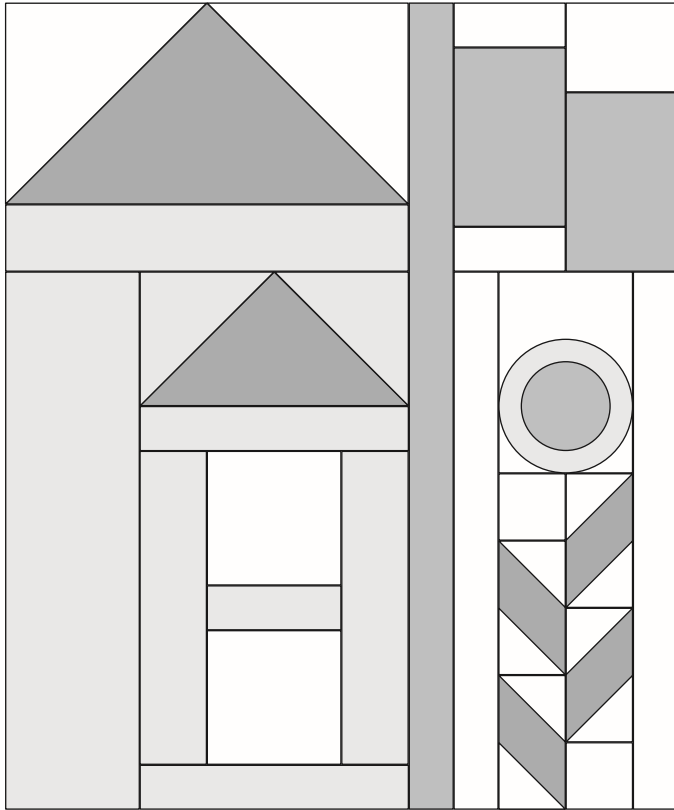

- 2 House Roof Small**  
 Draw a diagonal line from corner to corner on the wrong side of 2-3½" house squares. Layer a 3½" marked house square, right sides to together, on 1-6½" x 3½" small roof rectangle as shown. Sew, trim, and press. Repeat on the the opposite end of the same rectangle. Make 1.

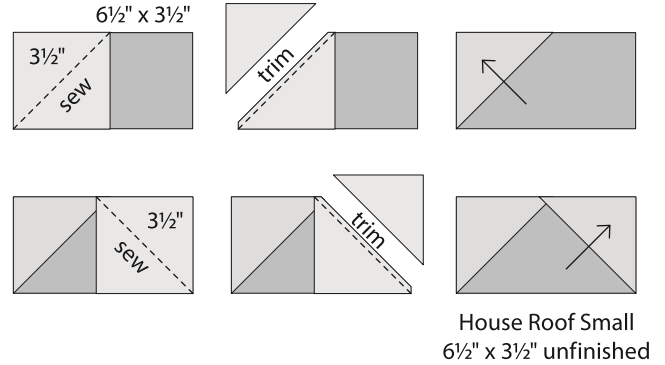

- 3** Assemble the house as shown.

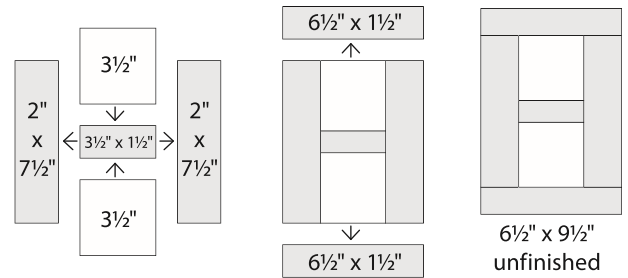

## Construction

Use ¼" seams. Press in the direction of the arrows in the diagrams.

- 1 House Roof Large**  
 Draw a diagonal line from corner to corner on the wrong side of 2-5" background squares. Layer a 5" marked background square, right sides to together, on 1-9½" x 5" roof rectangle as shown. Sew on the diagonal line. Trim ¼" from the sewn line. Press to reveal the triangle. Repeat on the the opposite end of the same rectangle. Make 1.

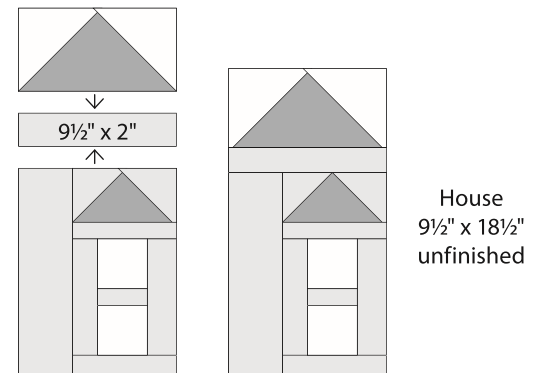
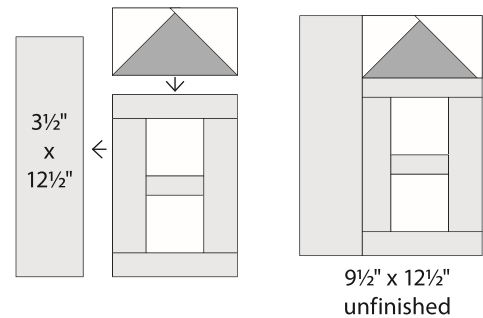
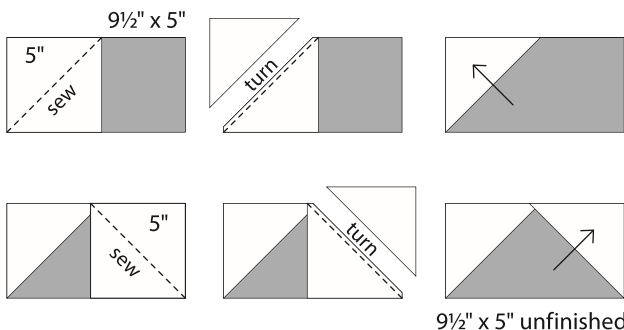

# 4 Flower

(A) Draw a diagonal line from corner to corner on the wrong side of 8-2" background squares. Layer a 2" marked background square, right sides to together, on 1-2" x 3 1/2" leaf rectangle as shown. Sew on the diagonal line. Trim 1/4" from the sewn line. Press to reveal the triangle. Repeat on the the opposite end of the same rectangle. Make 2 leaf As and 2 leaf Bs. *Note the 2" square placement is different.*

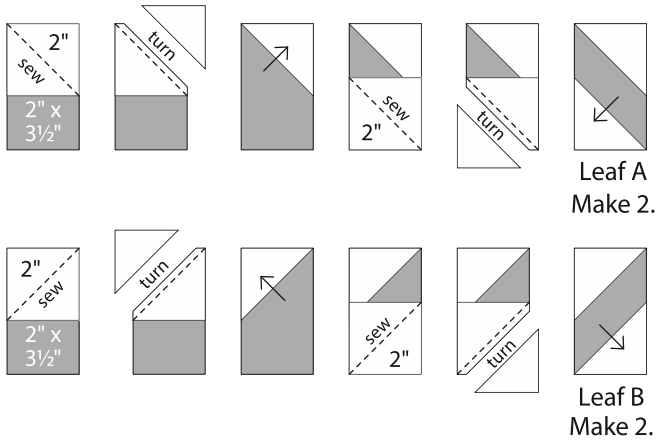

(B) Arrange and sew 2-Leaf As and 1-2" background square to make column A. Arrange sew 1-2" background square and sew 2-Leaf Bs to make column B. Join the columns, add a 3 1/2" x 5" background rectangle. Add 2-1 1/2" x 12 1/2" background rectangles. Use you appliqué method of choice to add the circles.

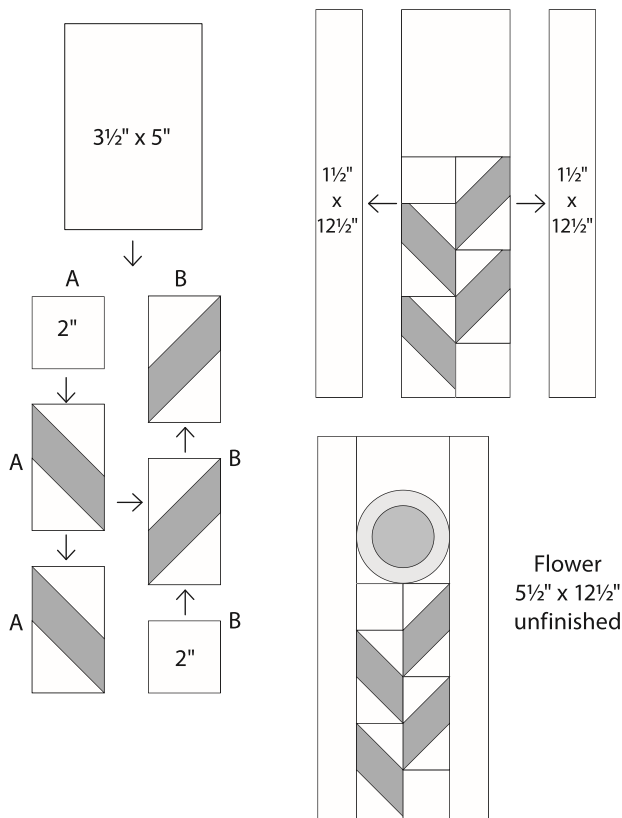

# 5 Assemble the flag as shown.

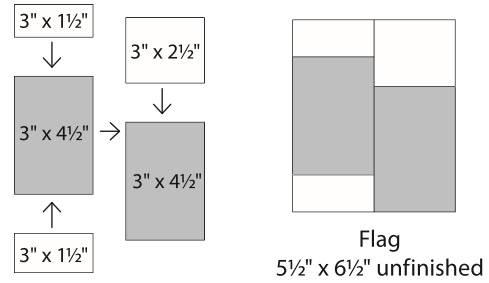

*moda*

# 6 Assemble the block as shown.

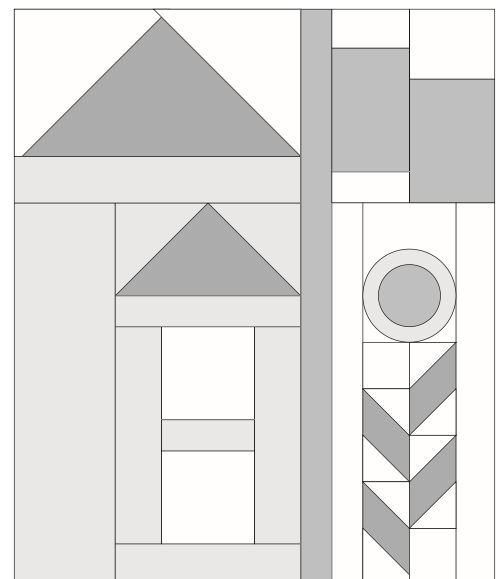
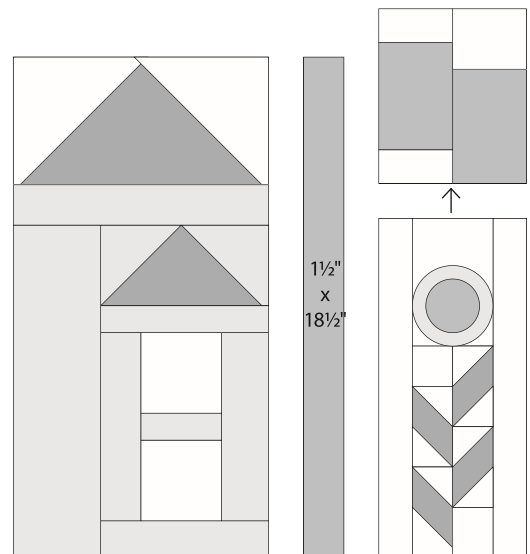

**Block 8**  
15 1/2" x 18 1/2" unfinished





*moda*

# Be My Neighbor

**Block 9**  
15" x 18" finished

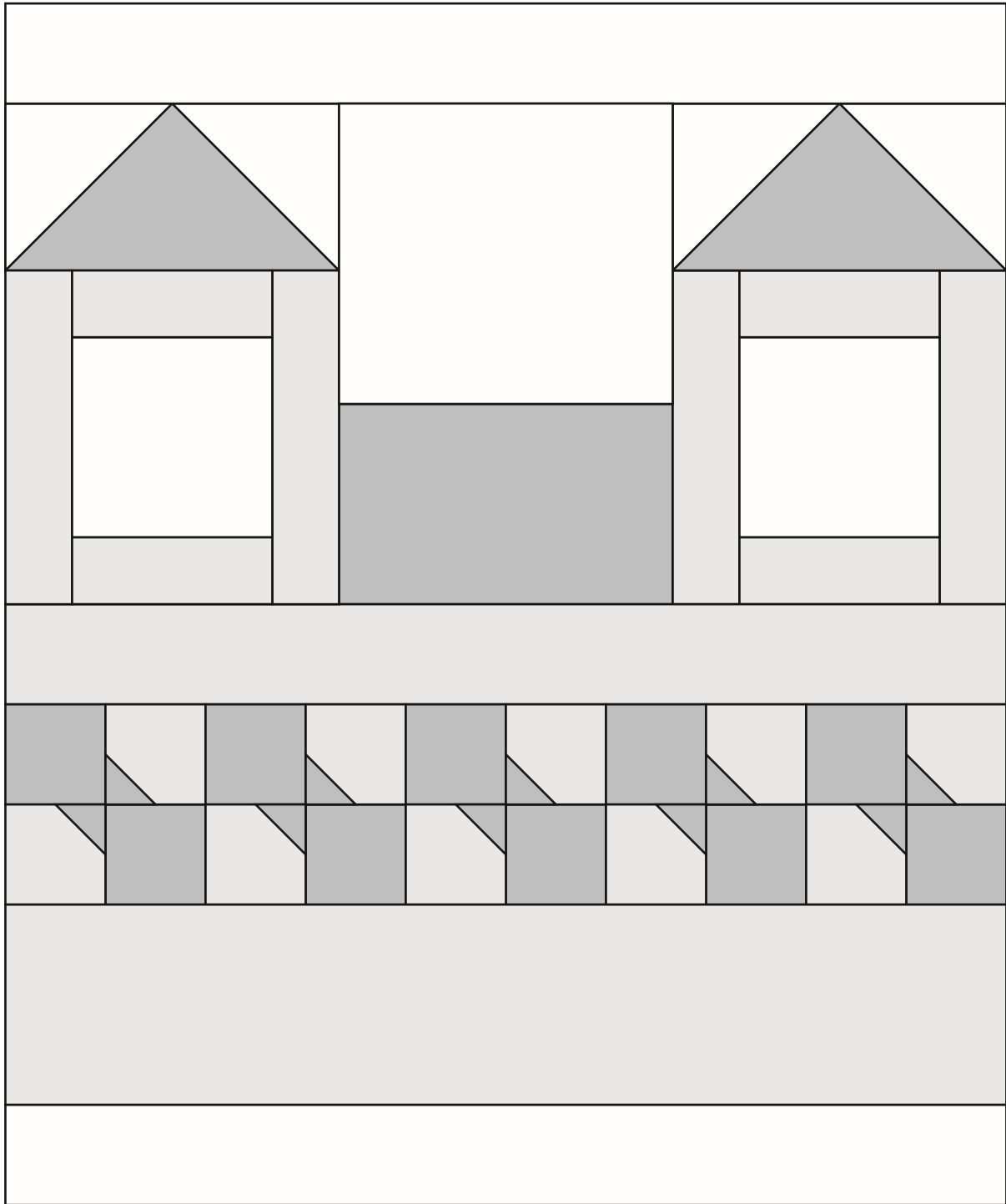

## General Information

- These are very scrappy blocks. Mix your favorite Moda prints to create your colorful neighborhood!
- Share your progress and final quilt at #BeMyNeighbor. We love to see your results!!!

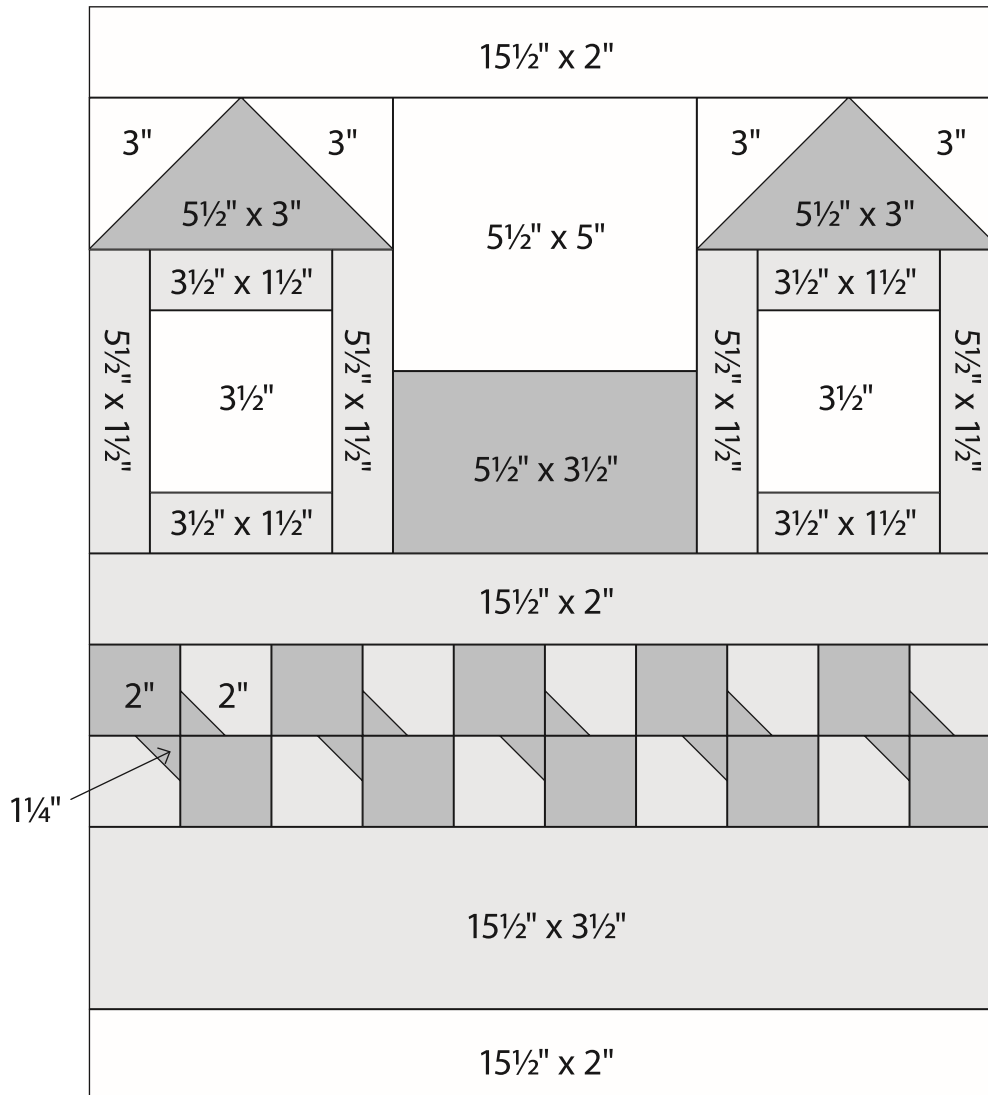

**Block 9**  
15½" x 18½" unfinished

## Cutting

### House Roof

- 1–5½" x 3½" rectangle
- 2–5½" x 3" rectangles

### Bowties (5 total)

- For EACH bowtie cut
- 2–2" squares and 2–1¼" squares

### Windows

- 2–3½" squares

### House

- 1–15½" x 3½" rectangle
- 1–15½" x 2" rectangle
- 10–2" squares
- 4–5½" x 1½" rectangles
- 4–3½" x 1½" rectangles

### Background

- 2–15½" x 2" rectangles
- 1–5½" x 5" rectangles
- 4–3" squares

# Be My Neighbor

Block 9 is 15" x 18" finished.

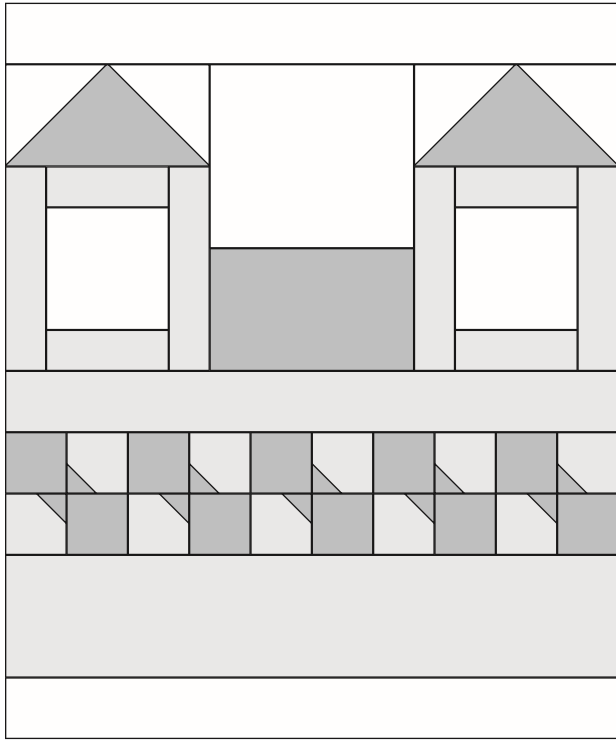

House Rooftops and Windows continued . . .

(B) Assemble windows and rooftops as shown.

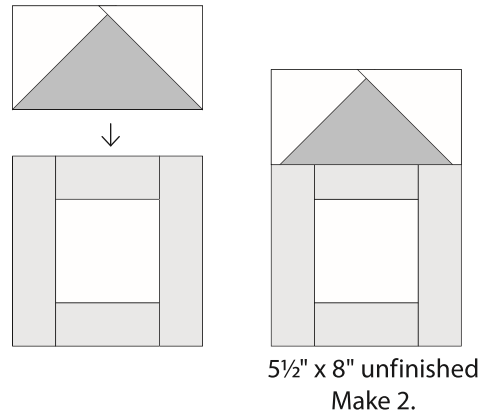
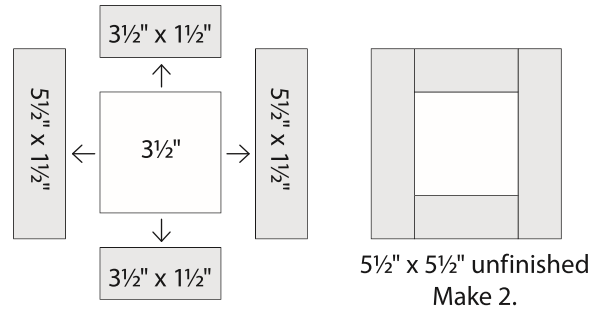

## Construction

Use 1/4" seams. Press in the direction of the arrows in the diagrams.

### 1 House Rooftops and Windows

(A) Draw a diagonal line from corner to corner on the wrong side of 4-3" background squares. Layer a 3" marked background square, right sides to together, on 1-5 1/2" x 3" roof rectangle as shown. Sew on the diagonal line. Trim 1/4" from the sewn line. Press to reveal the triangle. Repeat on the opposite end of the same rectangle. Make 2.

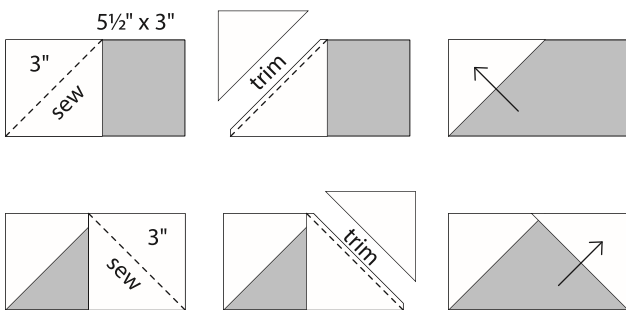

House  
5 1/2" x 3" unfinished  
Make 2.

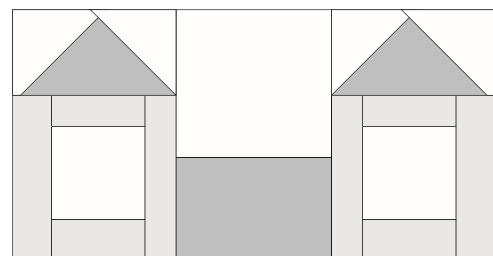
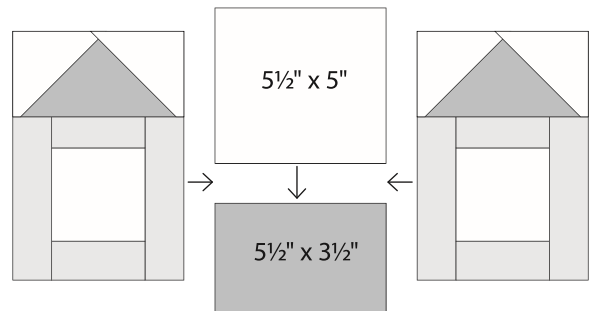

15 1/2" x 8" unfinished

## 2 To make one Bowtie

(A) Draw a diagonal line from corner to corner on the wrong side of 2-1 1/4" bowtie squares. Layer a 1 1/4" marked bowtie square, right sides together, on 1-2" house square as shown. Sew on the diagonal line. Trim 1/4" from the sewn line. Press to reveal the triangle.

Make 2.

Arrange and sew 2 rows of 1-2" bowtie square and 1 bowtie as shown. Join the rows. Repeat to make bowties.

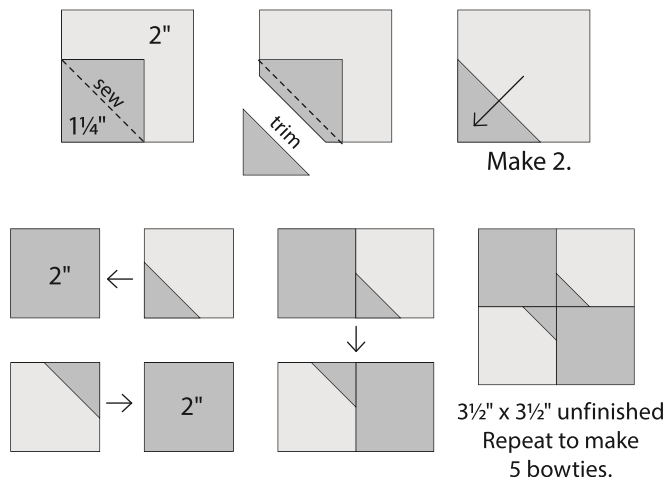

(B) Join the 5 bowties in one row.

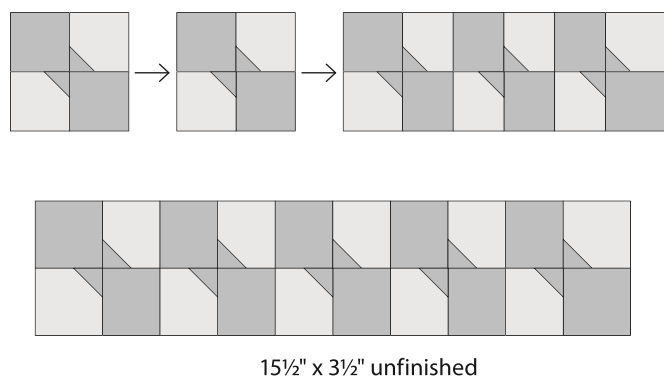

*moda*

## 3 Assemble the block as shown.

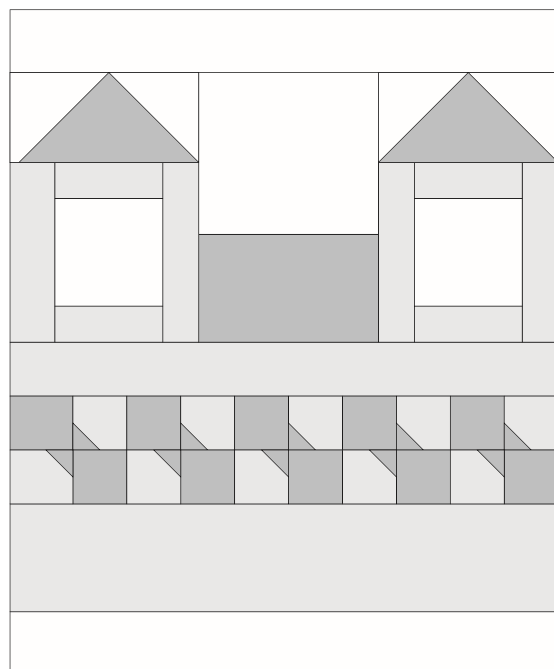
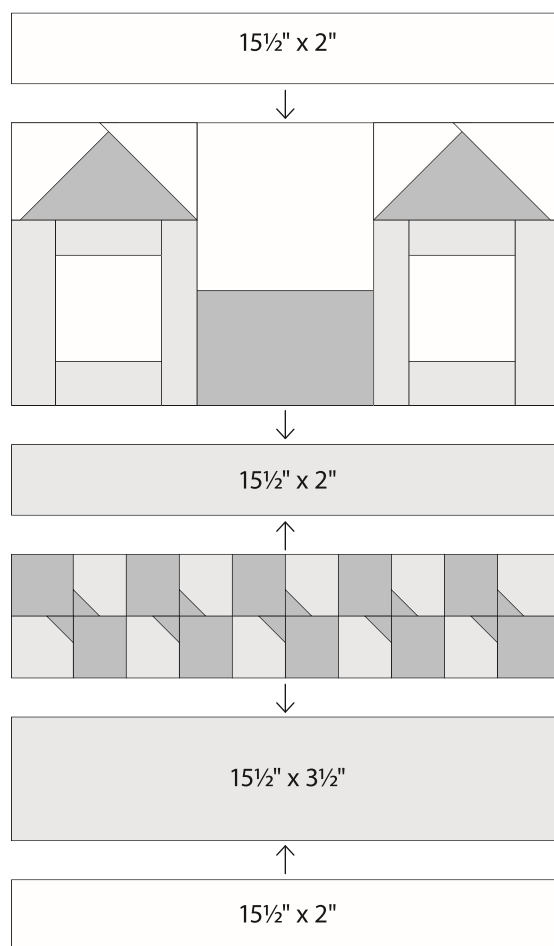

Block 9   
 15 1/2" x 18 1/2" unfinished