



moda

Be My Neighbor

Block 1

18" x 18" finished

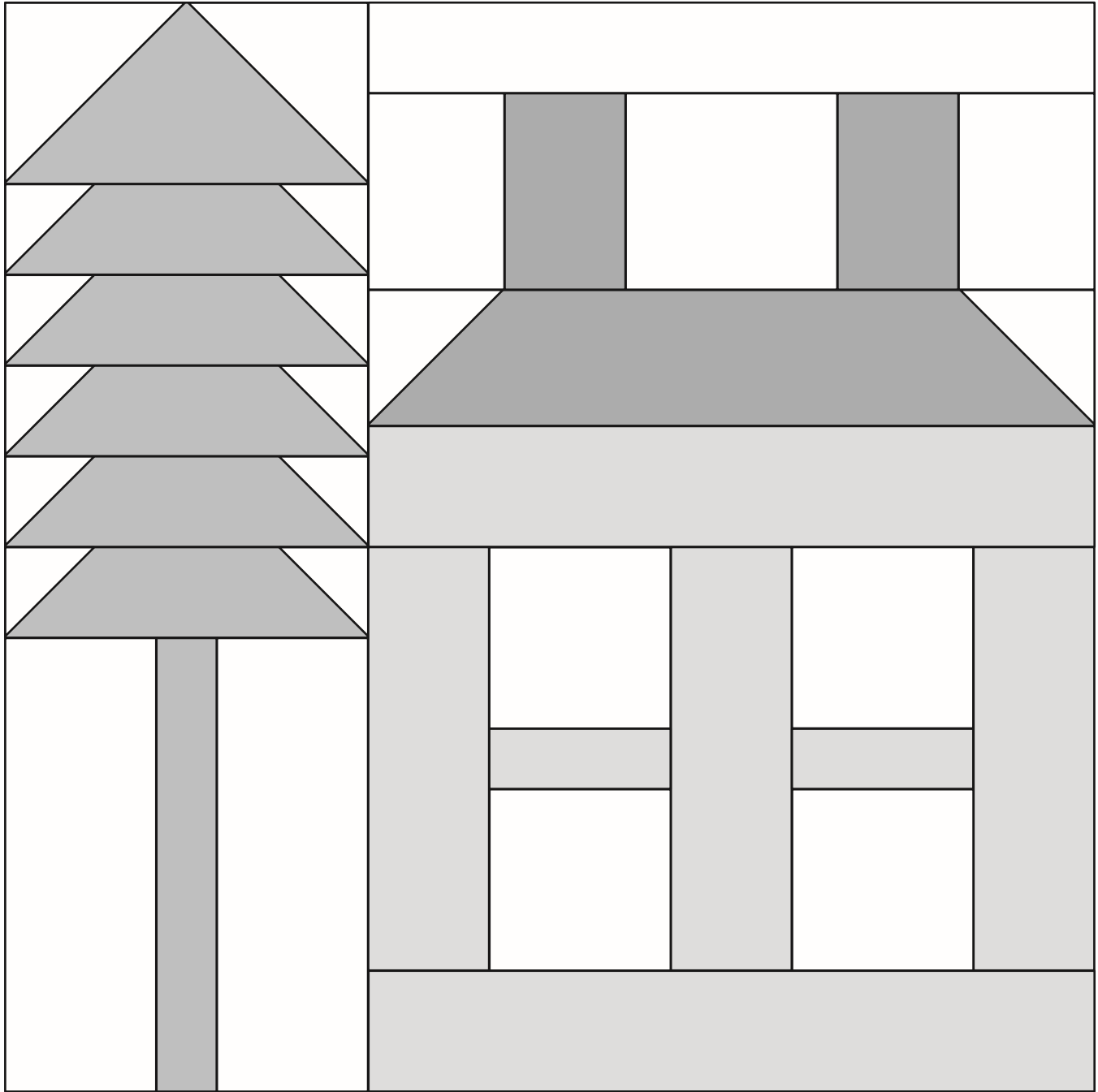

General Information

- These are very scrappy blocks. Mix your favorite Moda prints to create your colorful neighborhood!
- Share your progress and final quilt at #BeMyNeighbor. We love to see your results!!!

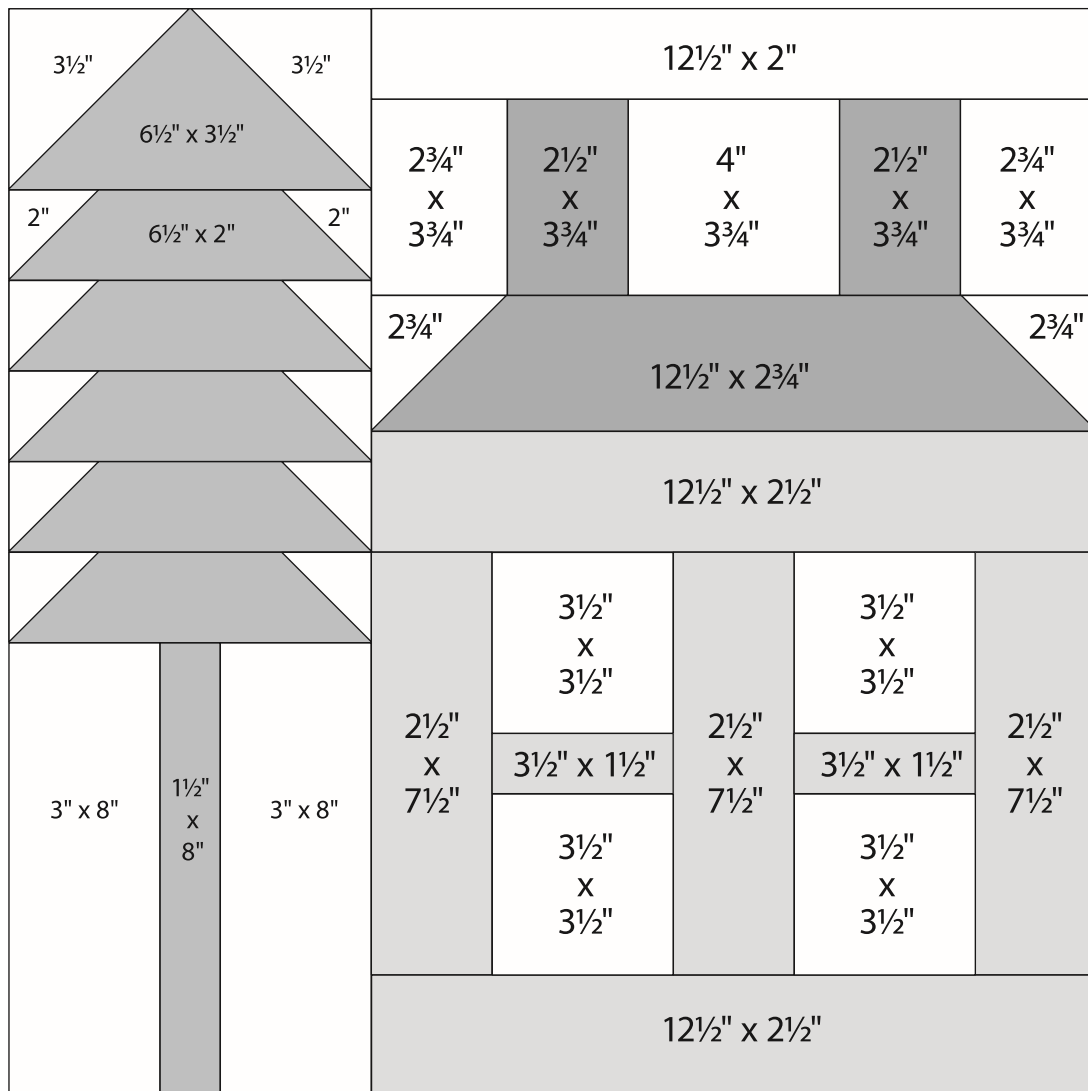

Block 1
18½" x 18½" unfinished

Cutting

House

- 2–12½" x 2½" rectangles
- 2–3½" x 1½" rectangles
- 3–2½" x 7½" rectangles

Windows

- 4–3½" squares

Roof and Chimneys

- 1–12½" x 2¾" rectangle
- 2–2½" x 3¾" rectangles

Tree

- 1–6½" x 3½" rectangle
- 5–6½" x 2" rectangles

Tree Trunk

- 1–1½" x 8" rectangle

Background

- 10–2" squares
- 1–2" x 12½" rectangle
- 2–2¾" squares
- 2–2¾" x 3¾" rectangles
- 1–3¾" x 4" rectangle
- 2–3" x 8" rectangles
- 2–3½" squares



moda Be My Neighbor

Block 1 is 18" x 18" finished.

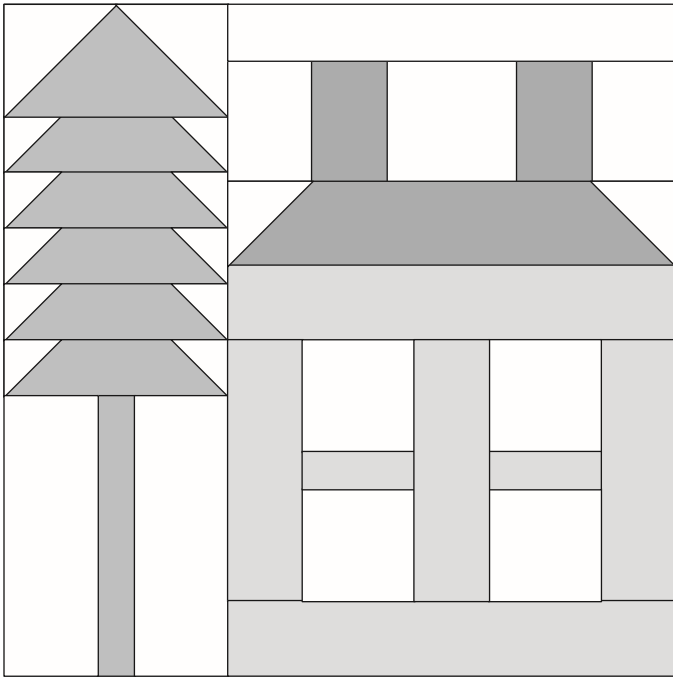

Construction

Use $\frac{1}{4}$ " seams. Press in the direction of the arrows in the diagrams.

1 Tree

(A) Draw a diagonal line from corner to corner on the wrong side of $2-3\frac{1}{2}$ " background squares. Layer a $3\frac{1}{2}$ " marked background square, right sides together, on $1-6\frac{1}{2}$ " x $3\frac{1}{2}$ " tree rectangle as shown. Sew on the diagonal line. Trim $\frac{1}{4}$ " from the sewn line. Press to reveal the triangle. Repeat on the opposite end of the same rectangle. Make 1.

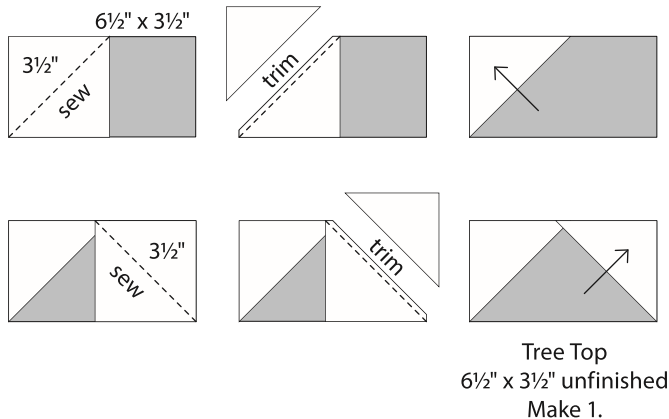

tree continued

(B) Draw a diagonal line from corner to corner on the wrong side of $10-2$ " background squares. Layer 2" marked background square, right sides together, on $1-6\frac{1}{2}$ " x 2 " tree rectangle as shown. Sew on the diagonal line. Trim $\frac{1}{4}$ " from the sewn line. Press to reveal the triangle. Repeat on the opposite end of the same rectangle. Make 5.

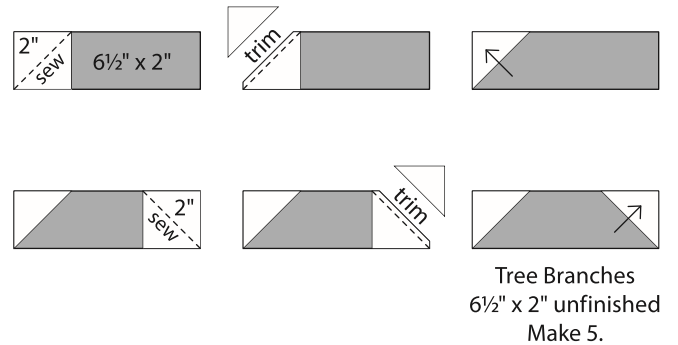

(C) Join $2-3$ " x 8 " background and $1-1\frac{1}{2}$ " x 8 " tree trunk as shown. Make 1.

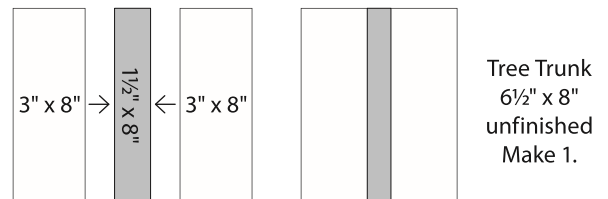

(D) Assemble the tree as shown.

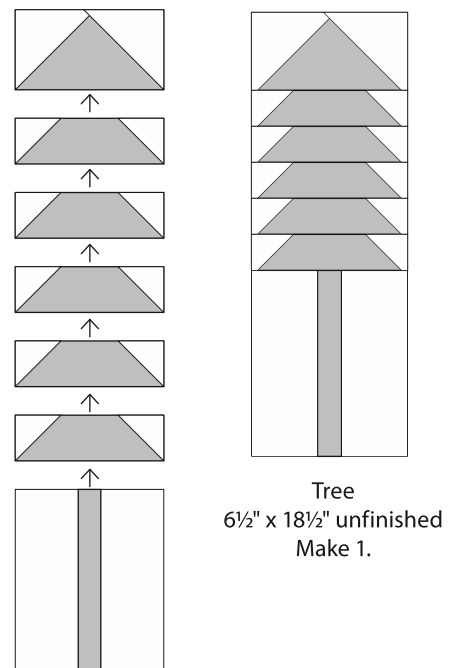

2 Chimney, Roof, and Windows

(A) Join 2-2 $\frac{3}{4}$ " x 3 $\frac{3}{4}$ " backgrounds, 2-2 $\frac{1}{2}$ " x 3 $\frac{3}{4}$ " chimneys, and 1-4" x 3 $\frac{3}{4}$ " background as shown to make the chimneys.

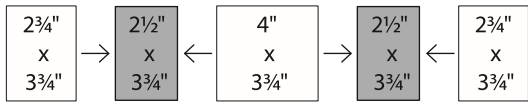

Chimneys
18 $\frac{1}{2}$ " x 3 $\frac{3}{4}$ " unfinished
Make 1.

(B) Draw a diagonal line from corner to corner on the wrong side of 2-2 $\frac{3}{4}$ " background squares. Layer a 2 $\frac{3}{4}$ " marked background square, right sides to together, on 1-12 $\frac{1}{2}$ " x 2 $\frac{3}{4}$ " roof rectangle as shown. Sew on the diagonal line. Trim $\frac{1}{4}$ " from the sewn line. Press to reveal the triangle. Repeat on the opposite end of the same rectangle.

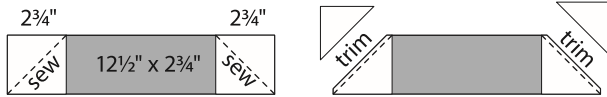

Roof
12 $\frac{1}{2}$ " x 2 $\frac{3}{4}$ " unfinished
Make 1.

(C) Assemble the windows as shown.

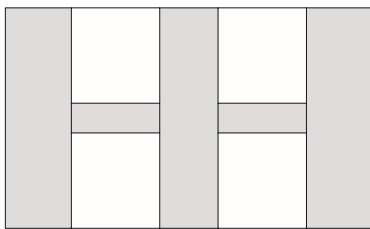
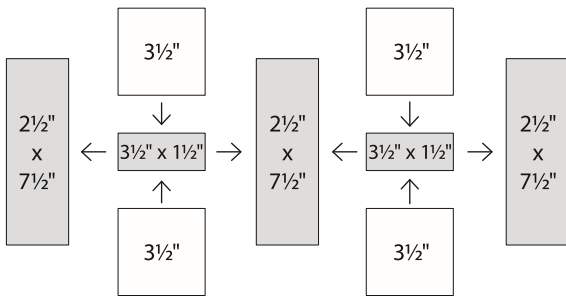

Window
12 $\frac{1}{2}$ " x 7 $\frac{1}{2}$ " unfinished
Make 1.

3 Assemble the house as shown.

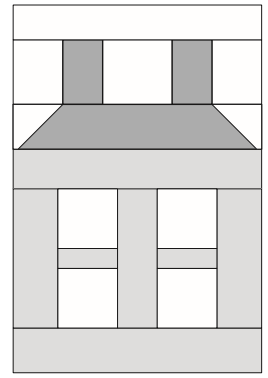
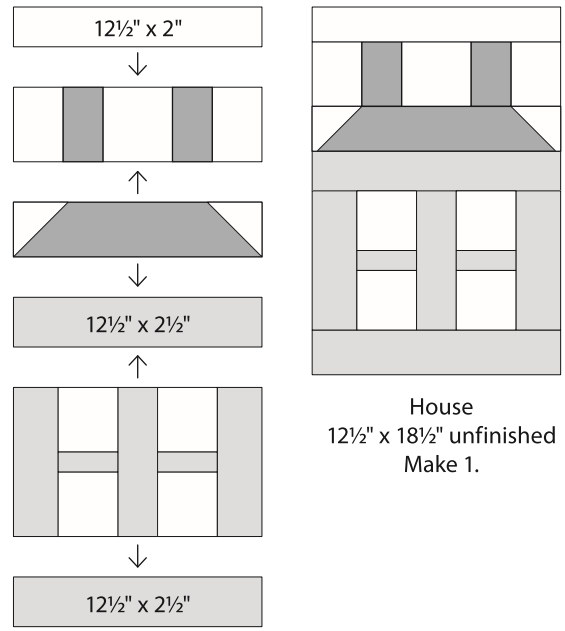

House
12 $\frac{1}{2}$ " x 18 $\frac{1}{2}$ " unfinished
Make 1.

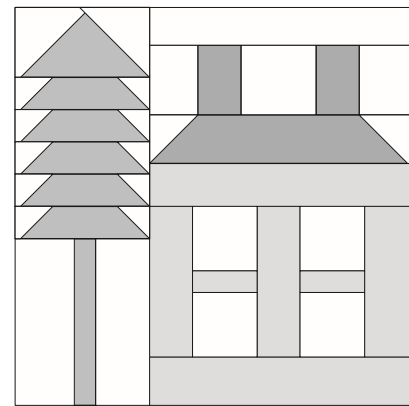
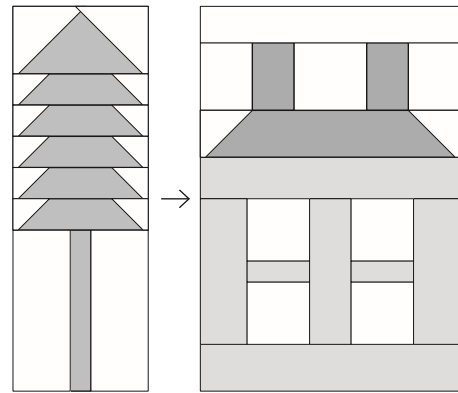

Block 1
18 $\frac{1}{2}$ " x 18 $\frac{1}{2}$ " unfinished.

moda